

Instruction and parts manual



RE2, REN2
TFE2
RE4, RE8
REE2, REEN2
REE4

Manual N°: MA020414-11ENG
Publishing date: 07-11-2025

Language: ENG
Revision 11

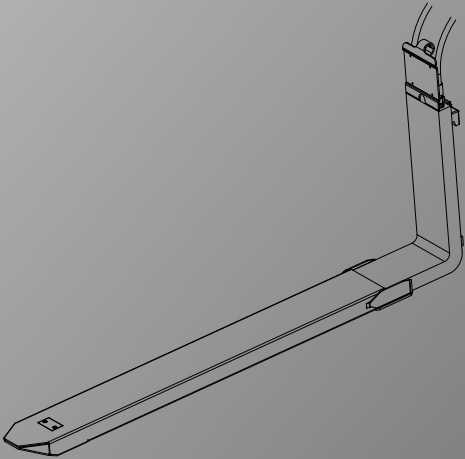

Table of contents

Definitions	2
Note	2
Quality Standards/Norms and Directives	2
Safety	3
Identification	4
Assembly	5
Working with KOOI-REACHFORKS®	6
Maintenance Schedule	6
Wear	7
Instructions for Replacement of Sleeve	8
Replacement of Hydraulic Parts	9
Troubleshooting	11
Replacement parts list RE2, REN2	13
Replacement parts list RE2 (cont'd)	14
Replacement parts list RE2 (cont'd)	15
Replacement parts list RE2 (cont'd)	16
Replacement parts list TFE2	17

Replacement parts list RE4	18
Replacement parts list RE4 (cont'd)	19
Replacement parts list RE4 (cont'd)	20
Replacement parts list RE8	21
Replacement parts list REE2, REEN2	22
Replacement parts list REE4	23
Replacement parts list REE4 (cont'd)	24

Definitions



Warning:

Text blocks marked by a “Warning” icon (as shown on the left) and starting with the text “**Warning:**” provide information on actions which may result in serious injury.



Caution:

Text blocks marked by a “Caution” icon (as shown on the left) and starting with the text “**Caution:**” provide information on actions which may result in damage to the KOOI-REACHFORKS®, parts of the KOOI-REACHFORKS® or goods.

“*Only applies to:*” texts (italics) indicate that a text only applies to a certain situation or certain type of KOOI-REACHFORKS®.

Note

© Copyright 2006 - 2025, Meijer Handling Solutions B.V. All rights reserved.

Unless otherwise indicated, information provided in this manual, including but not limited to illustrations and text, may not be reproduced without the prior written permission of Meijer Handling Solutions.

The information in this manual is provided without any form of guarantee. Under no circumstances shall Meijer Handling Solutions B.V. be held liable for accidents or damages arising from the use of this manual.

Please note that information in this manual may be changed at any time without prior notice and that it may contain technical inaccuracies and typing errors. Meijer Handling Solutions B.V. makes every effort to avoid errors in this manual, but cannot guarantee this. Please let us know if you encounter any typing errors or technical inaccuracies, or if you have any suggestions.

KOOI-REACHFORKS® is a registered trademark of Meijer Handling Solutions. (Gebr. Meijer).

Other trade or product names used in this manual, but not mentioned here, are the trademarks of their respective holders.

Quality Standards/Norms and Directives

Meijer Handling Solutions B.V. complies with the following quality standards: ISO 9001

KOOI-REACHFORKS® comply with the following norms/directives:

- ISO 13284 – Fork Arm Extensions and Telescopic Fork Arms;
- ISO 4406 – Hydraulic Fluid Power – Fluids – Method for Coding the Level of Contamination by Solid Particles
- ISO 2328 – Forklift Trucks – Hook-On Type Fork Arms and Fork Arm Carriages
- CE (2006/42/EC) – Machinery Directive
- ISO-FDIS-ISO 3834-2 – Quality Requirements for Fusion Welding of Metallic Materials – Part 2: Comprehensive Quality Requirements
- CE (2014/43/EG) – ATEX (**only applies to forks with an ATEX name plate!**)

KOOI-REACHFORKS® are randomly subjected to dynamic testing in accordance with ISO 2330.

Safety

**Warning:**

The operator should be trained and familiarized with the local regulations for operating a forklift truck.

**Warning:**

Do not ride on the KOOI-REACHFORKS® or on the load.

**Warning:**

Do not walk or stand under the KOOI-REACHFORKS®.

**Warning:**

Do not reach through the mast of the forklift truck.

**Warning:**

Do not load the KOOI-REACHFORKS® beyond the limits of the lifting capacities and load centre stipulated by the manufacturer.

**Warning:**

Do not weld anything onto the KOOI-REACHFORKS® without the express permission of the supplier. Welding carried out without permission shall void any warranty.

**Warning:**

Do not use faulty KOOI-REACHFORKS® before they have been either professionally repaired or replaced.

**Warning:**

Do not carry out maintenance work on the KOOI-REACHFORKS® whilst there is pressure in the hydraulic system (remove key from forklift ignition switch).

**Warning:**

Do not clamb loads onto the KOOI-REACHFORKS® when the outer forks are extended.

**Warning:**

Do not place limbs between pallet stops and the inner fork (vertical section) of the KOOI-REACHFORKS®. If the load shifts, limbs can become trapped which can result in serious injury.

**Warning:**

Do not use the KOOI-REACHFORKS® in areas where the temperature is below -30°C (-22°F) unless otherwise agreed with the manufacturer.

**Warning:**

Temperature differences can cause pressure to build up in a plugged hydraulic product, which can lead to the plug shooting out of the coupling if the swivel is being removed without releasing the pressure first. In the case of a plugged product, partially loosen the coupling swivels and give the plug a slight tap with a tool (i.e. wrench) until it is loose. At this time oil might flow out of the coupling, releasing any buildup pressure. Next, completely unscrew the swivels and plugs from the product.

**Caution:**

When leaving the forklift the engine must be switched off and the handbrake applied.

**Caution:**

Bear in mind the space above and beneath the KOOI-REACHFORKS®.

**Caution:**

The load must be distributed as evenly as possible on the KOOI-REACHFORKS®.

**Caution:**

Retract the (loaded) KOOI-REACHFORKS® as soon as possible.

**Caution:**

If possible, retract the KOOI-REACHFORKS® before driving.

**Caution:**

Always drive with the KOOI-REACHFORKS® in the lowest possible position.

**Caution:**

Ensure that dismantled KOOI-Reachforks can not turn over by depositing the fork back on the ground.

Identification

Type plate legend:

	Type description		Weight
	Serial number		Max. capacity on retracted load center
	Retracted center of gravity		Max. capacity on extended load center
	Extended center of gravity		Maximum allowed oil pressure
	Retracted load center		Production year
	Extended load center		Extra information



WARNING: Never exceed the maximum truck capacity as seen on the truck type plate. Rated capacity of both truck and attachment is the responsibility of the original truck manufacturer and may be less than the capacity shown on the attachments type plate.

Mounting type description of K00I-REACHFORKS®:

type															
No. of cylinders per set															
Capacity per fork x 100 kg															
retracted length (mm)															
stroke (mm)															
mounting															

Assembly

- 1 The KOOI-REACHFORKS® type plates are stamped with an 'L' and an 'R'. Mount the KOOI-REACHFORKS® on the left (L) and right (R) as viewed from the forklift operator's seat.

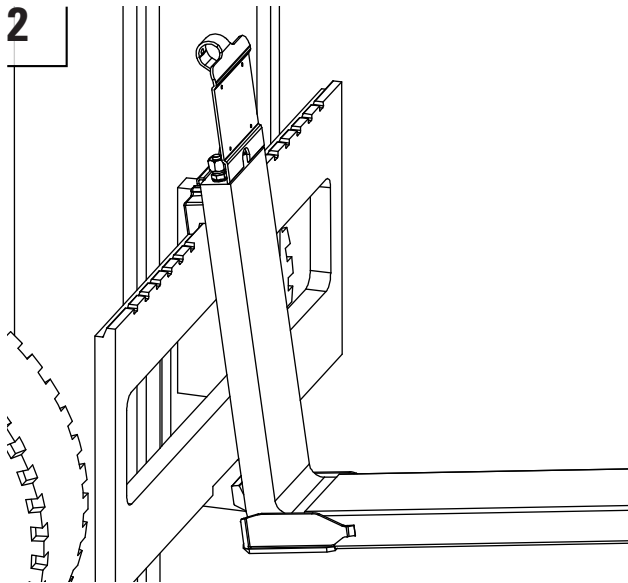

Slide the KOOI-REACHFORKS® onto the carriage plate.

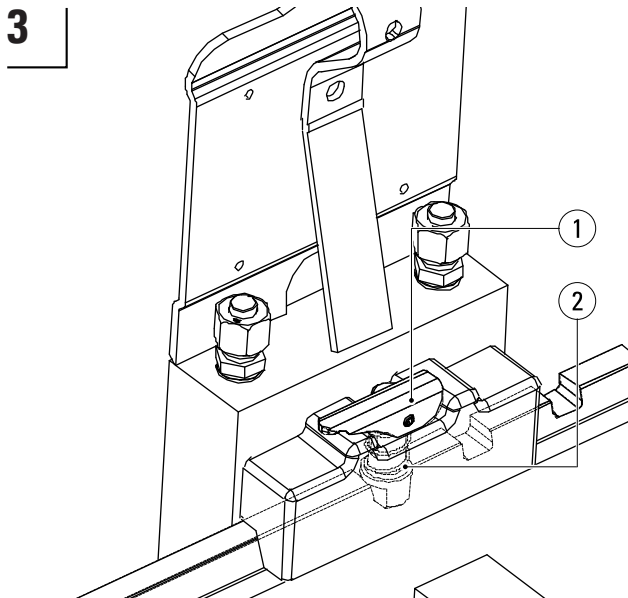

Make sure that each of the KOOI-REACHFORK® locking pins (2) drops into one of the notches on the carriage plate. Use catch (1) before operating.



Caution:

To avoid back injury, hold the fork arm at the tip and the fork blade to set the fork arms to the required spacing. Keep a straight back at all times!

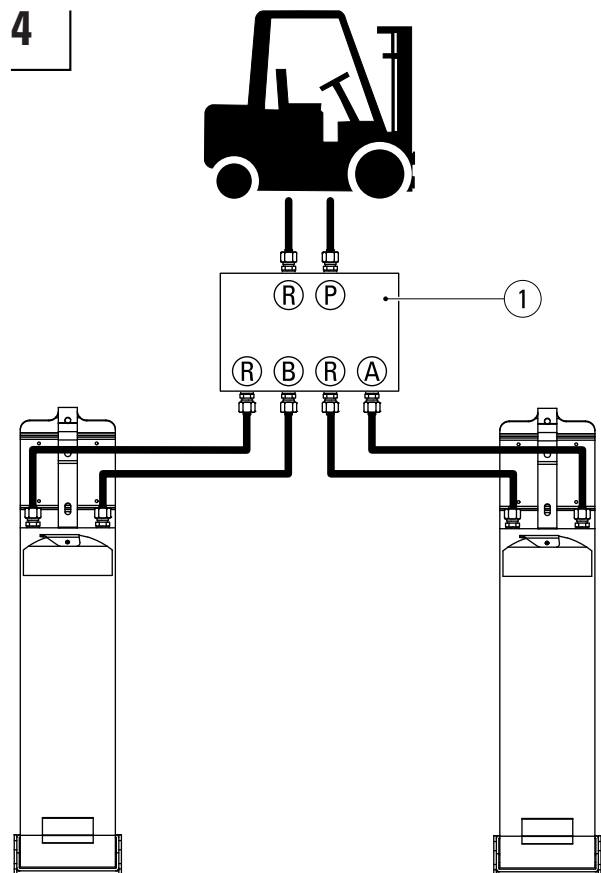

Connect the KOOI-REACHFORKS® to the hydraulic system via the flow divider (1).

Type KOOI-REACHFORKS®	Recommended oil flow	Recommended hose diameter	Maximum operating pressure	Connection
All types	8-25 (L/min) 2.1-6.6 (gal/min)	1/4"	250 bar (3626 psi)	8L / 7/16" JIC (USA) / 9/16" (USA)

5

- Slide the KOOI-REACHFORKS® in and out 10x.
- Tilt the forklift mast back and forth a few times.
- Slide the KOOI-REACHFORKS® in and out 10x again.

Check that hydraulic hoses are unobstructed and that there are no oil leakages.







Working with KOOI-REACHFORKS®

The KOOI-REACHFORKS®, type RE, are connected via a flow divider that enables both forks to slide in and out simultaneously. The accuracy of the flow divider allows a maximum length discrepancy of 4% while sliding the KOOI-REACHFORKS® in and out.

To minimise wear, avoid allowing the KOOI-REACHFORKS® to come in contact with the ground during operation . In order to reduce wear:

- The manufacturer can weld a wear-resistant plate under the sleeve which can be replaced when worn out.
- The chains in the forklift mast can be shortened so that the KOOI-REACHFORKS® cannot reach the ground.

Maintenance Schedule

N°	Description	Weekly	Monthly	6 months or every 1000 hours	Annually or every 2000 hours
1.	Grease the underside and topside of the inner fork				
2.	Check inner fork for leaks				
3.	Check wear strips for any sign of wear*				
4.	Check sleeve for signs of wear, especially the heel side (REE/REEN type also wear plate)				
5.	Check for and remove any dirt in the sleeve				
6.	Check for any cylinder head leaks				
7.	Check inner forks in accordance with ISO 5057* standards				

*See chapter on 'Wear'.

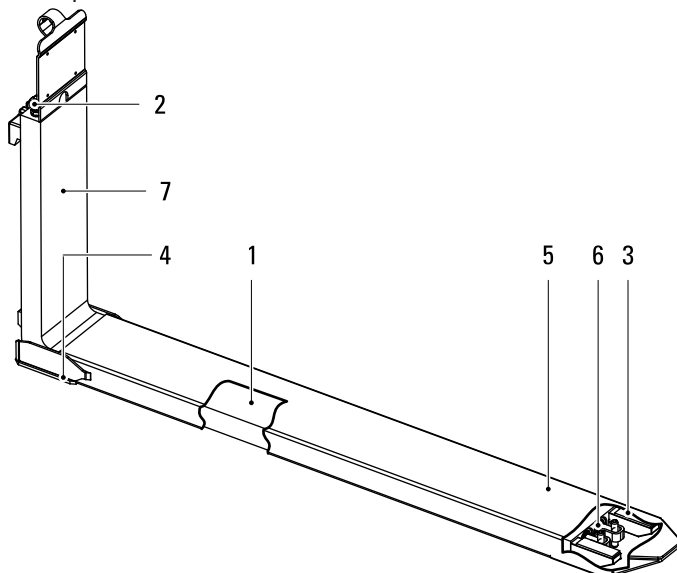

Notes on 'Maintenance Schedule'

- Recommended lubricating grease: Novatex EP2 (point 1).
- In the event of leakage, immediately remove the forks from the forklift and contact your supplier (point 2).
- If defects are detected, solve the problem / replace parts before proceeding to work with the KOOI-REACHFORKS®.
- See chapter on 'Instructions for Replacement of Sleeve' and 'Instructions for Replacement of Hydraulic Parts' for further explanation about replacing parts and required tools.

Wear

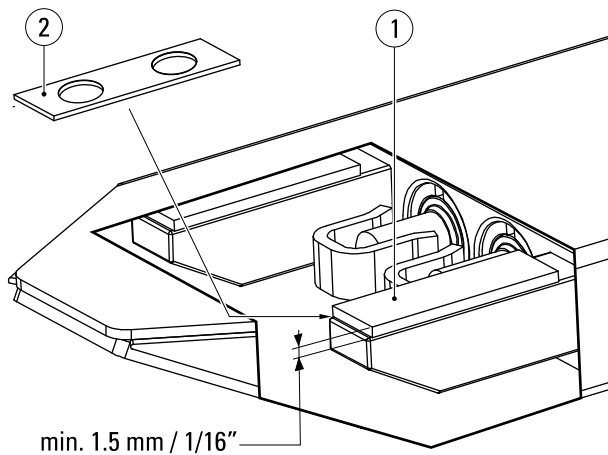

The thickness of Wear Strips (1) may not be less than 1.5 mm (1/16"). When Wear Strips (1) have worn to this thickness, replace them or fill with spacers (2) (Art. N° RE0092002). See point 3 of the Maintenance Schedule.

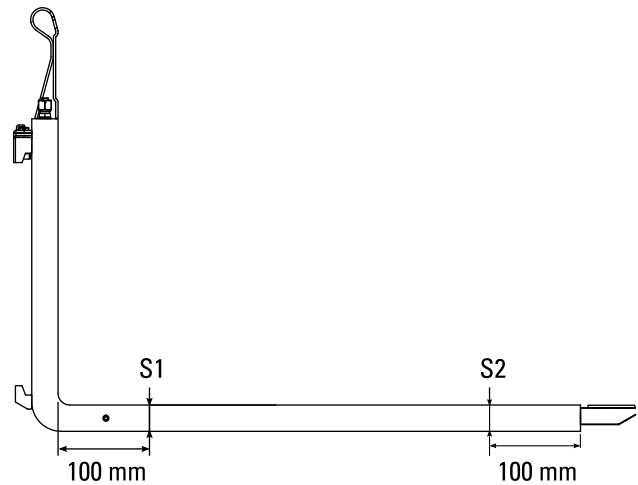

The inner fork must be replaced when S1 is 5% thinner than S2. See point 7 of the Maintenance Schedule.

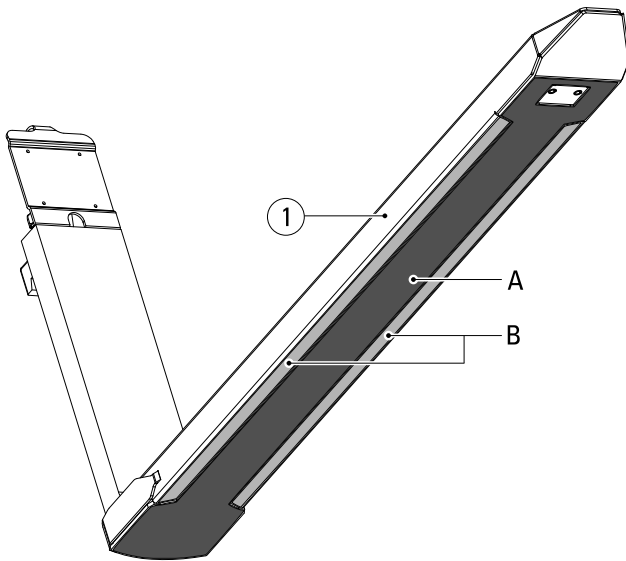

When surface A (dark grey, integrated wear plate) is worn to the extent that it is level with or below surface B (light grey), then the sleeve (1) must be replaced. See point 4 of the Maintenance Schedule.

Caution:

The sleeves must be removed from the KOOI-REACHFORKS® before welding work can proceed.
Pistons, piston rods and cylinder heads must be removed before welding is carried out in the inner fork.

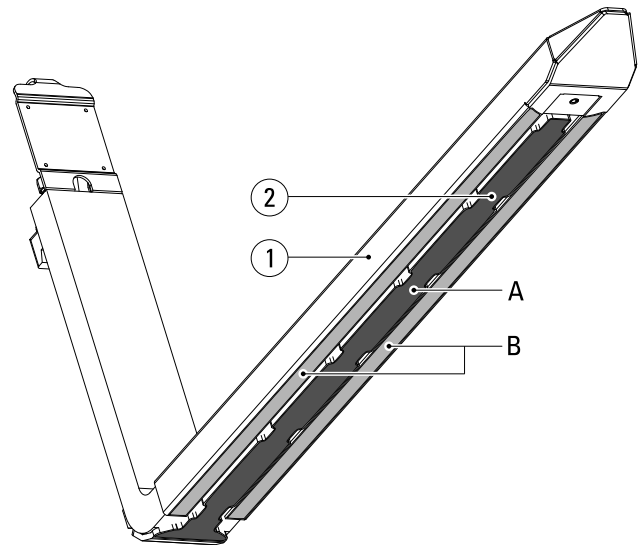

Applies only to: KOOI-REACHFORKS® type REE and REEN;
When surface A (dark grey, integrated wear plate) is worn to the extent that it is level with or below surface B (light grey), then the wear plate (2) must be replaced. If there are signs of wear in the lower side of the sleeve (1) then it must be replaced. See point 4 of the Maintenance Schedule.

Wear Plate Welding Data:

- Process: MAG (135), 210A, 28 VDC
- Weld type: fillet weld a4, 1 layer
- Cleaning: brush
- Wire: 1 mm, EN 12534 / Mn3Ni1CrMo
- Shielding gas: 80% Ar / 20% CO₂, 15-16 L/min
- Weld in wear-plate grooves

Instructions for Replacement of Sleeve

- 1** Position the KOOI-REACHFORKS® at hip height, tilt the mast of the forklift slightly forward and remove the key from the ignition switch of the forklift.



Warning:

Do not carry out maintenance work on the KOOI-REACHFORKS® whilst there is pressure in the hydraulic system (remove key from forklift ignition switch).

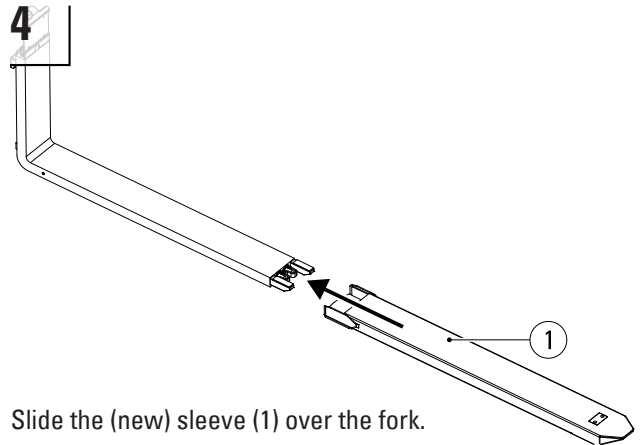

Slide the (new) sleeve (1) over the fork.

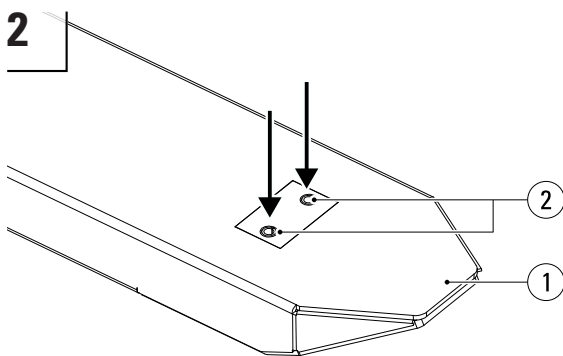

Tap the spring pins (2) out of the sleeve (1).

Tools required: Hammer, punch Ø10

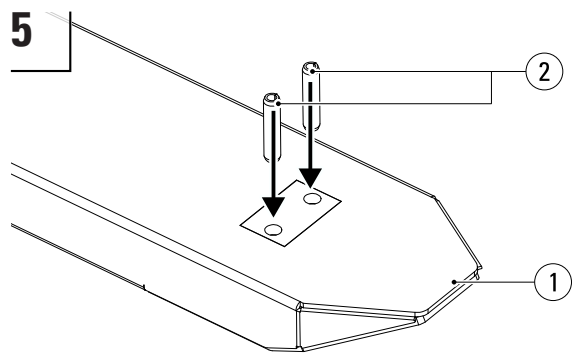

Tap the spring pin(s) (2) into the (new) sleeve (1).



Caution:

Ensure that the holes in the sleeve (1) are aligned with the opening in the bracket(s) that are welded onto the piston rod(s). DO NOT tap the spring pin onto the bracket or piston rod!

Tools required: Hammer.

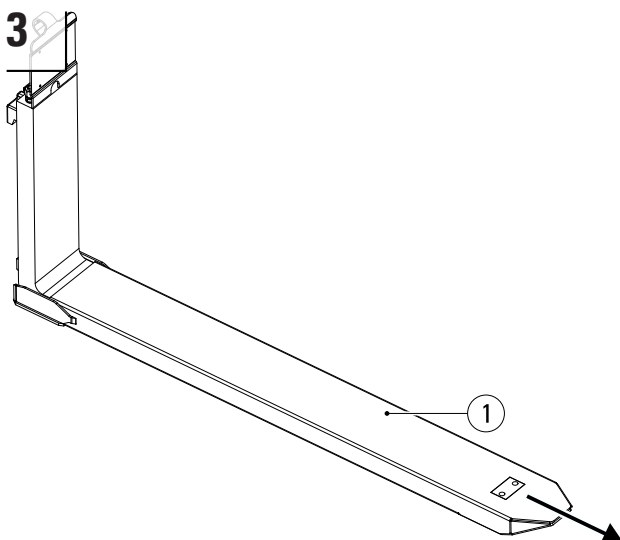

Pull the sleeve (1) off the fork.

Replacement of Hydraulic Parts

1 Follow steps 1 to 3 in chapter on 'Instructions for Replacement of Sleeve'.

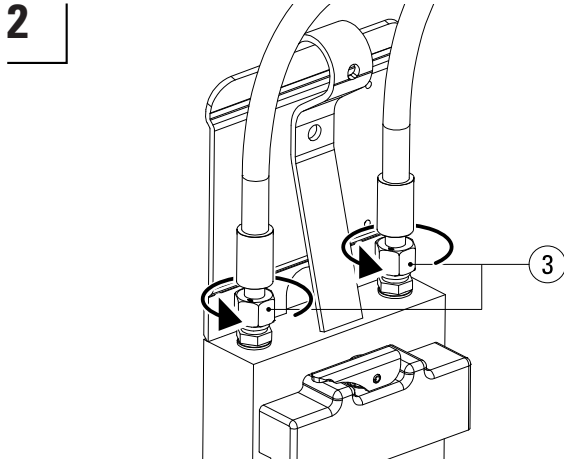

Loosen the hose connectors (3) slightly so that the pistons do not create a vacuum when removing the hydraulic parts.

Tools required: Open-ended spanner 17.

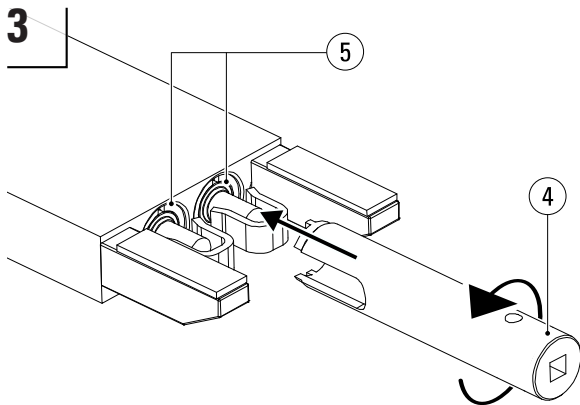

Place a drip tray below the fork. Unscrew the cylinder head(s) (5) using a cylinder head spanner (4) and a ratchet.

Tools required: Cylinder head spanner, 1/2" ratchet.

*Cylinder head spanners are only available from Meijer Handling Solutions B.V. (Art. N° RE0058034).

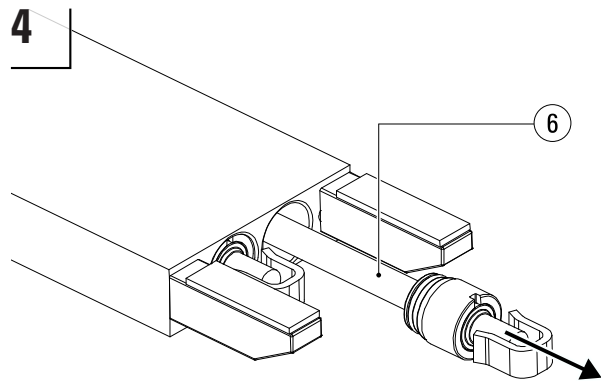

Pull the entire hydraulics set (6) consisting of the piston, cylinder head and piston rod out of the fork.



Caution:

Take care with the surface of the piston rod. Even minor damage to surface can cause leaks.

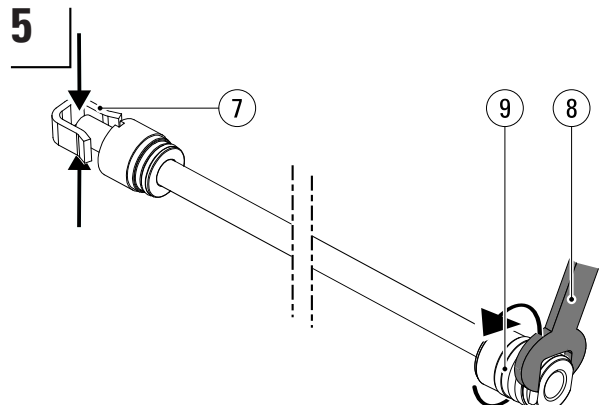

Clamp the piston rod at the rod end (7), not on the piston rod itself to prevent damage (see step 4 in this chapter). Use a size 19 or 24 (8) open-ended spanner to loosen the piston (9). If the piston cannot be loosened, heat the piston with a burner.

Tools required: Open-ended spanner 19 or 24, clamp.

Note: When heating the piston with a burner, it must be replaced due to the damage to the seals caused by heating.



Warning:

Do not use a burner in an area not equipped/intended for his purpose because of fire hazard.

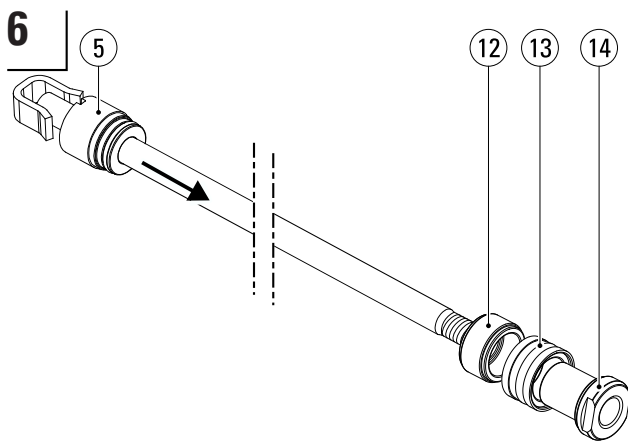

When the piston section 1 (14) has been removed the piston seal (13) can be replaced if necessary. When piston section 2 (12) is also removed, the cylinder head (5) can be removed, should it need to be replaced.

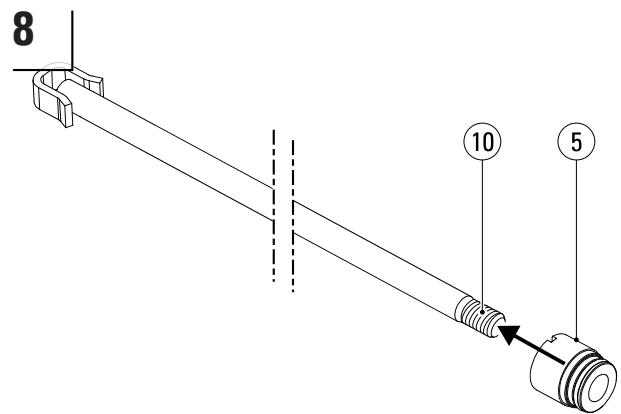

Slide the (new) cylinder head (5) onto the piston rod (10).



Caution:

Do not damage the cylinder head seals (5) during assembly as this can result in leakage. Pay particular attention when the sliding cylinder head (5) over the thread (10) of the piston rod.

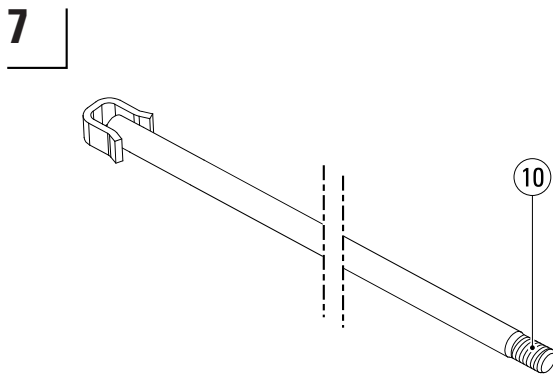

Remove remaining adhesive residue from the piston rod thread (10), then clean the piston rod and thread (10) using Loctite 7063¹.

Tools required: Loctite 7063¹.

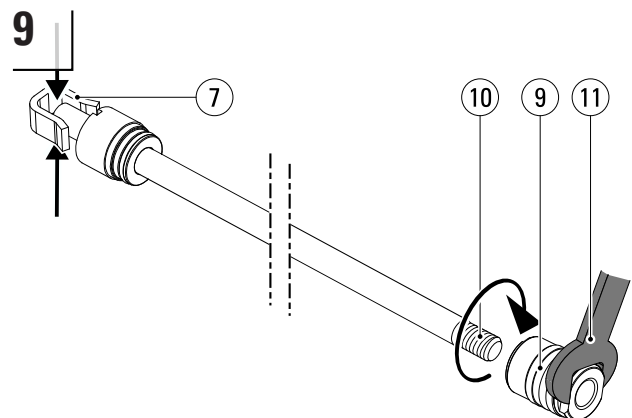

Apply Loctite 270 to the thread (10) of the piston rod ¹. Clamp the piston rod at the rod end (7), not on the piston rod itself to prevent damage (see step 4 in this chapter). Clean the piston thread with Loctite 7063¹. Use a torque wrench 19 or 24 (11) to tighten the piston (9) onto the piston rod (10) to a torque of 70 Nm.

Tools required: Loctite 270¹, Loctite 7063¹, torque wrench 19 or 24.

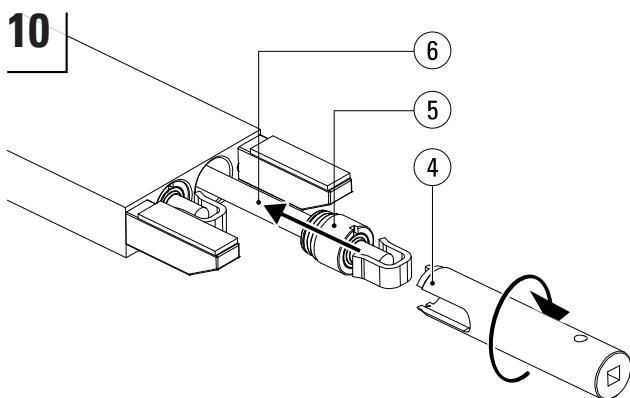

Smear Copaslip² onto the thread of the cylinder head (5). Line up the hydraulic set (6) with the cylinder and use a hammer to tap it carefully into the bore. Screw the cylinder head tight using the cylinder head spanner (4) and a torque wrench. See table below for torque values.

Tools required: Hammer, Copaslip², cylinder head spanner*, 1/2" torque wrench.

Cylinder diameter (mm)	Torque (Nm)	Article N°
25	80	RE0058037
30	80	RE0058034
35	80	RE0058034

*Cylinder head spanners are only available from Meijer Handling Solutions B.V.



Caution:

Do not damage the piston or cylinder head seals during assembly as this can result in leakage.

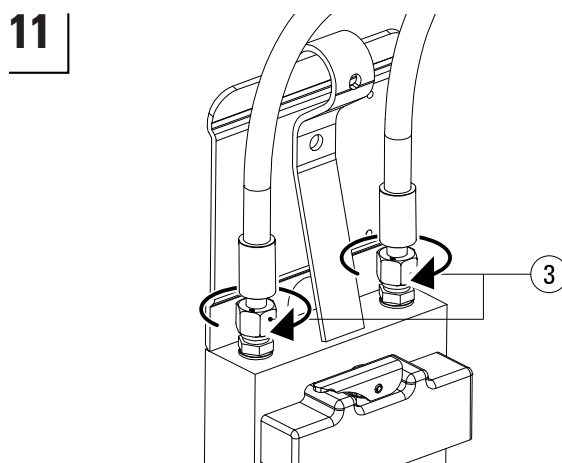

Screw the hose connectors (3) tight.

Tools required: Open-ended spanner 22.

12 Follow steps 4 to 5 in chapter on 'Instructions for Replacement of Sleeve'.

13 Finally, follow step 5 of the chapter on 'Assembly'.

¹ See www.loctite.com

² See www.kroon-oil.com

Troubleshooting

Observation	Symptom	Possible Cause	Possible Solution
Oil leak	Oil leak between cylinder head and piston rod	Bent piston rod	Replace piston rod and cylinder head
		Scratched/damaged piston rod	
	Oil leak between cylinder head and fork blade.	Leaking cylinder head seal	Replace cylinder head
		Leaking O-Ring	Replace cylinder head
	Oil leak at connector	Leaking copper ring	Replace copper ring
		Loose connector	Tighten connector
	Forks leaking oil	One or both KOOI-REACH-FORKS® are cracked	Remove KOOI-REACH-FORKS® from carriage immediately and contact supplier.

Forks moving unevenly (more than 4%)	Forks not moving in unison	A piston seal is leaking	Replace the piston with the leaking seal
		The hydraulic hoses have been wrongly connected	Connect the hoses as indicated in chapter on 'Assembly'
		The length of the piston rods is unequal	Install piston rods of equal length
		Flow of hydraulic oil is not between 8-25 L/min	Please contact your supplier.
		Dirt in the sleeve(s)	Dismantle sleeve and remove dirt
		Flow divider is damaged	Replace flow divider
	One or both sleeves move without being operated	The control valve is leaking	Inform your forklift supplier.
		There is air in the hydraulic system	Bleed the system
		A piston seal is leaking	Replace the piston with the leaking seal
	One sleeve remains stationary during retraction then suddenly retracts quickly	Clamping bush(es) broken	Replace the clamping bush(es)
	One of the sleeves fails to retract		
Difference in length between the sleeves	Stroke length difference	Piston rods are not same length.	Please contact your supplier.
		Loose piston	Dismantle outer fork, remove hydraulic set from fork and tighten piston (70 Nm)
Difference in height between forks	One fork point hangs lower than the other	One of the KOOI-REACH-FORKS® has been permanently deformed as a result of overloading.	Remove KOOI-REACH-FORKS® from carriage immediately and contact supplier
		One of the KOOI-REACH-FORKS® is not hanging on the carriage plate	Hang the KOOI-REACH-FORK® properly onto the carriage plate (check locking mechanism)
		Carriage plate is not completely horizontal	Please do contact your forklift truck supplier.
		The forks do not match (forks belong to different sets)	Check serial N°s.
		Wear strips on one KOOI-REACHFORK® are more worn than the other	Replace wear strips
	Excessive play between fork blade and sleeve	Wear strips worn out	Replace sleeves
		Sleeves worn out	

Replacement parts list RE2, REN2

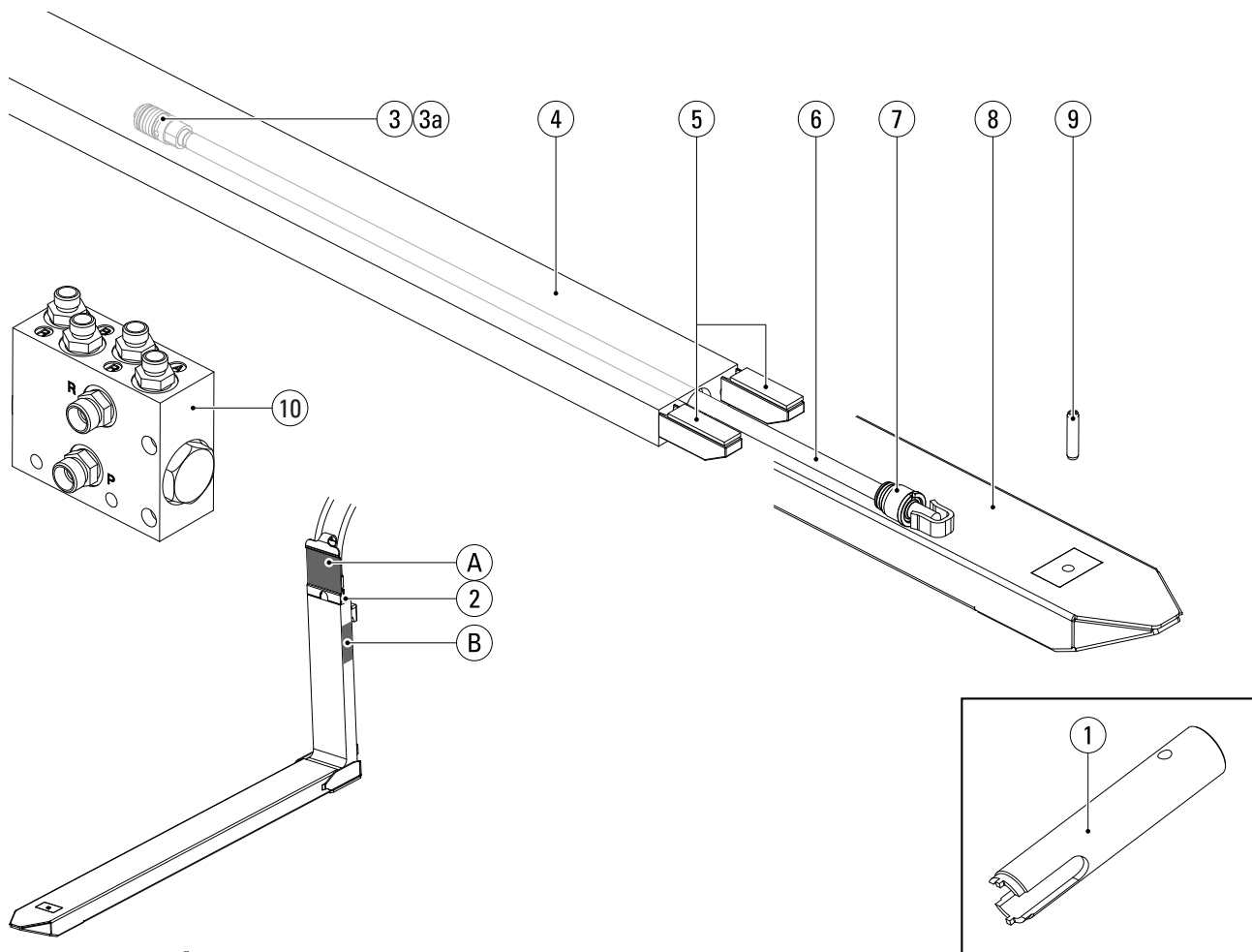

Pos. N°	Description	Article N°	Number of parts per set and type of forks			
			RE2-20	RE2-30	REN2-30	REN2-35
1	Cylinder head spanner	RE0058034	1 ¹	1 ¹	1 ¹	1 ¹
2	Straight male coupling 8L	RE2017000	4	4	4	4
3	Piston Ø30 (for piston rod Ø20)	RE2008001	2	2	2	2
3a	Loose piston seal Ø30	RE0015001	2	2	2	2
4	Inner fork	²	2	2	2	2
5	Wear strip PA6	RE0020000	4	4	4	4
6	Piston rod Ø20	²	2	2	2	2
7	Cylinder Head Ø30 (for piston rod Ø20)	RE2009001	2	2	2	2
8	Sleeve	²	2	2	2	2
9	Spring pin 55 mm	RE0033015	2	2	-	-
	Spring pin 65 mm	RE0033014	-	-	2	2
10	Flow divider	RE0100000	1	1	1	1
A	Type plate					
B	Engraved type information and serial number					

¹Available separately from KOOI-REACHFORKS® supplier, is **not** supplied as standard with KOOI-REACHFORKS®.

²Article N° depending on specific model. Please provide serial number when ordering.

Replacement parts list RE2 (cont'd)

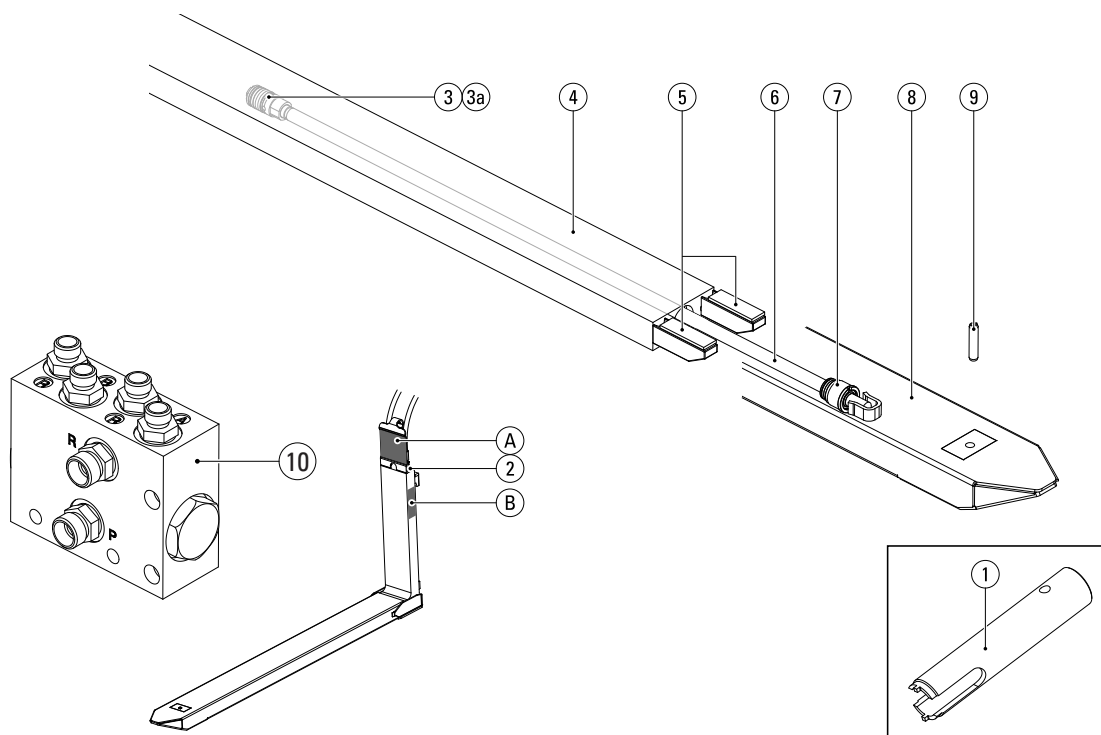

Pos. N°	Description	Article N°	Number of parts per set and type of forks				
			RE2-25	RE2-32	RE2-35	RE2-45	RE2-58
1	Cylinder head spanner (Ø30/35)	RE0058034	1 ¹	-	1 ¹	1 ¹	1 ¹
	Cylinder head spanner (Ø25)	RE0058037	-	1 ¹	-	-	-
2	Straight male coupling 8L	RE2017000	4	4	4	4	4
3	Piston Ø25 (for piston rod Ø16)	RE2009000	-	2	-	-	-
	Piston Ø30 (for piston rod Ø20)	RE2008001	2	-	2	2	-
	Piston Ø35 (for piston rod Ø20)	RE2008004	-	-	-	-	2
3a	Separate piston seal Ø25	RE0015000	-	2	-	-	-
	Separate piston seal Ø30	RE0015001	2	-	2	2	-
	Separate piston seal Ø35	RE0015004	-	-	-	-	2
4	Inner fork	²	2	2	2	2	2
5	Wear strip PA6	RE0020000	4	4	4	-	-
	Wear strip AMPCO	RE0020001	-	-	-	4	4
6	Piston rod Ø16	²	-	2	-	-	-
	Piston rod Ø20	²	2	-	2	2	2
7	Cylinder Head Ø25 (for piston rod Ø16)	RE0009000	-	2	-	-	-
	Cylinder Head Ø30 (for piston rod Ø20)	RE2009001	2	-	2	2	-
	Cylinder Head Ø35 (for piston rod Ø20)	RE2009004	-	-	-	-	2
8	Sleeve	²	2	2	2	2	2
9	Spring pin 45 mm	10099293	-	2	-	-	-
	Spring pin 55 mm	RE0033015	2	-	2	2	-
	Spring pin 65 mm	RE0033014	-	-	-	-	2
10	Flow divider	RE0100000	1	1	1	1	1
A	Type plate						
B	Engraved type information and serial number						

¹Available separately from KOOI-REACHFORKS® supplier, is **not** supplied as standard with KOOI-REACHFORKS®.

²Article N° depending on specific model. Please provide serial number when ordering.

Replacement parts list RE2 (cont'd)

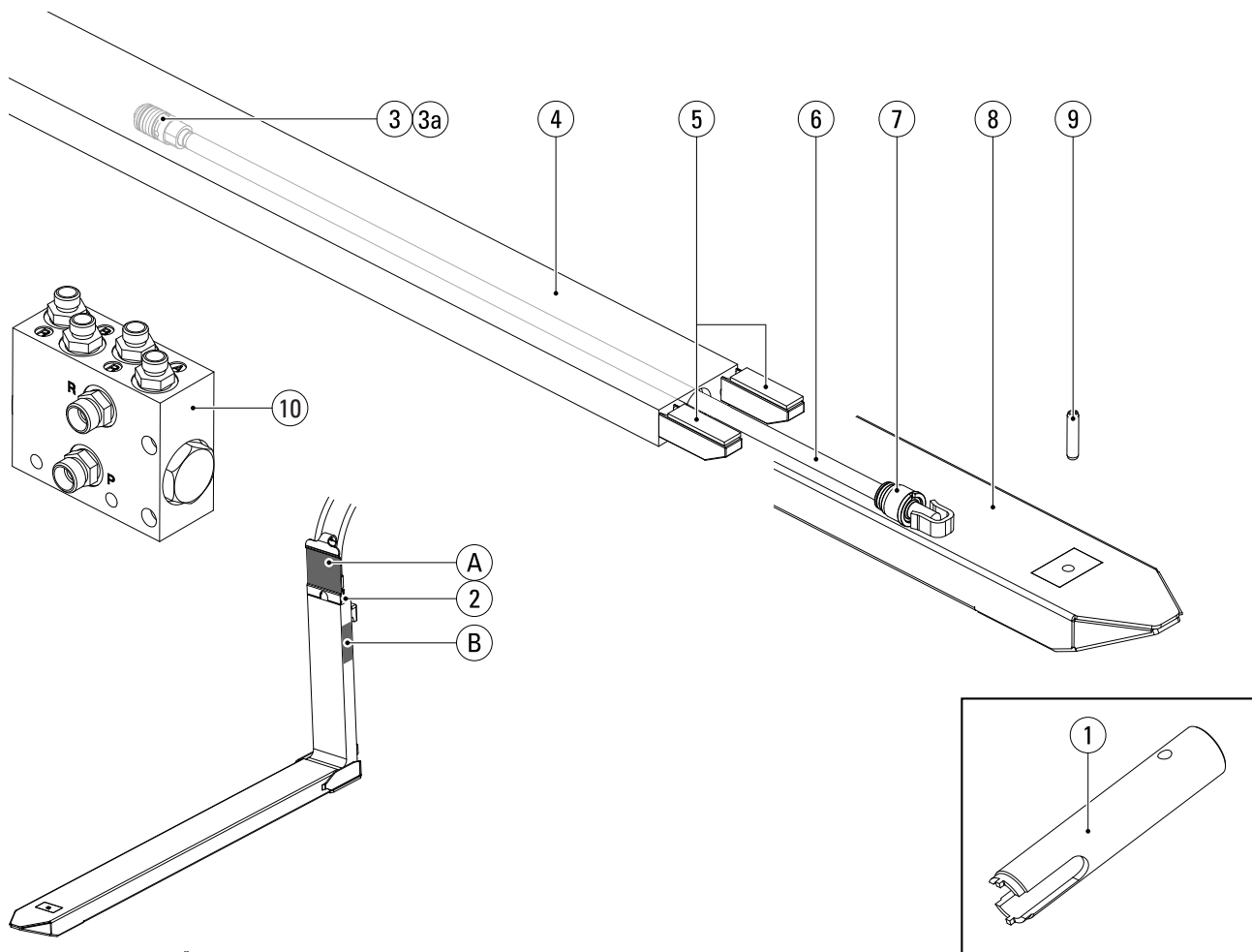

Pos. N°	Description	Article N°	Number of parts per set and type of forks	
			RE2-77	RE2-105
1	Cylinder head spanner	RE0058034	1 ¹	1 ¹
2	Straight male coupling 8L	RE2017000	4	4
3	Piston Ø35 (for piston rod Ø20)	RE2008004	2	2
3a	Separate piston seal Ø35	RE0015004	2	2
4	Inner fork	²	2	2
5	Wear strip AMPCO	RE0020001	4	4
6	Piston rod Ø20	²	2	2
7	Cylinder Head Ø35 (for piston rod Ø20)	RE2009004	2	2
8	Sleeve	²	2	2
9	Spring pin 65 mm	RE0033014	2	-
	Spring pin 75 mm	RE0033023	-	2
10	Flow divider	RE0100000	1	1
A	Type plate			
B	Engraved type information and serial number			

¹Available separately from KOOI-REACHFORKS® supplier, is **not** supplied as standard with KOOI-REACHFORKS®.

²Article N° depending on specific model. Please provide serial number when ordering.

Replacement parts list RE2 (cont'd)

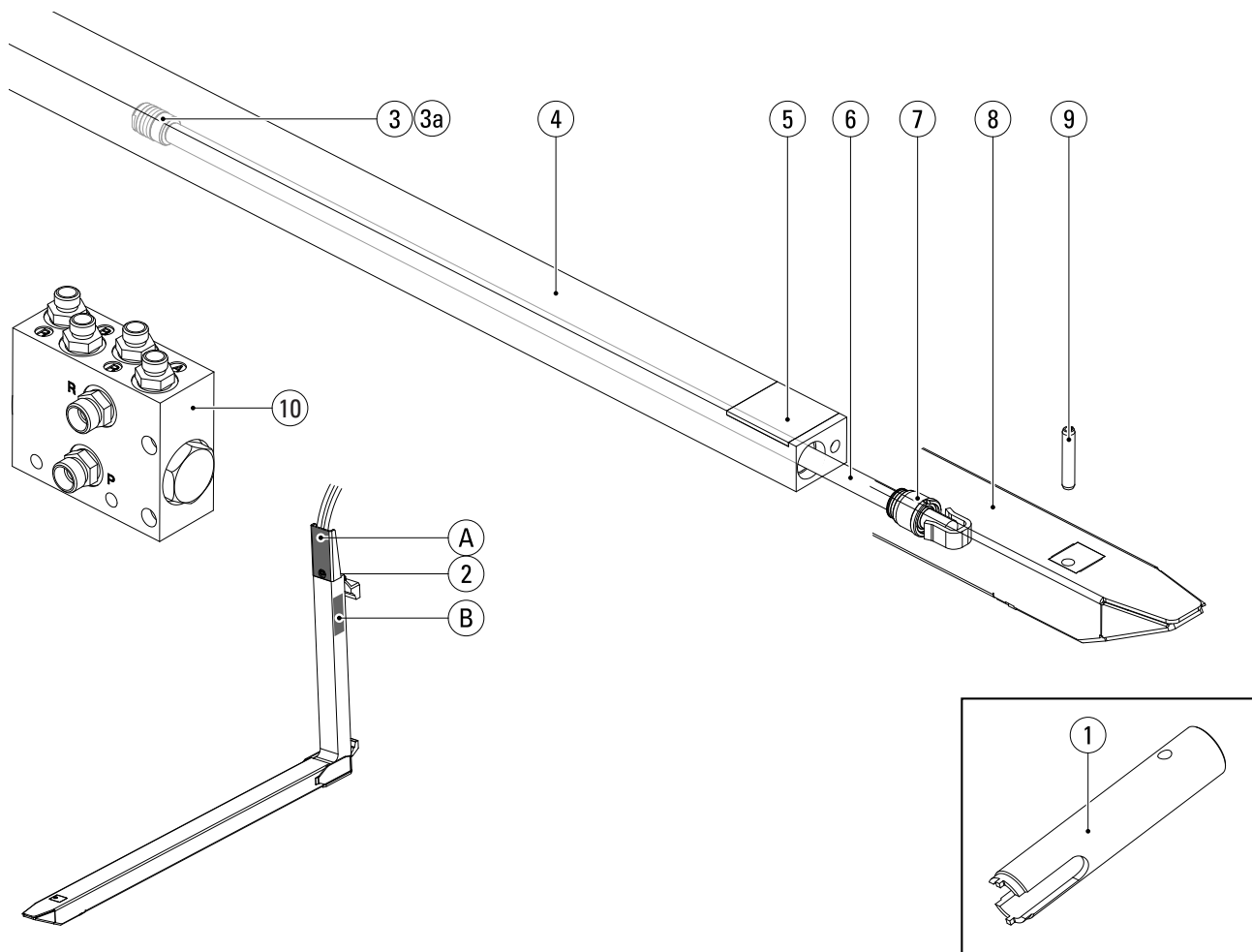

Pos. N°	Description	Article N°	Number of parts per set and type of forks	
			RE2-27	RE2-37
1	Cylinder head spanner	RE0058034	1 ¹	1 ¹
2	Straight male coupling 8L	RE2017000	4	4
3	Piston Ø30 (for piston rod Ø20)	RE2008001	2	2
3a	Separate piston seal Ø30	RE0015001	2	2
4	Inner fork	²	2	2
5	Wear strip AMPCO	RE0020002	2	2
6	Piston rod Ø20	²	2	2
7	Cylinder Head Ø30 (for piston rod Ø20)	RE2009001	2	2
8	Sleeve	²	2	2
9	Spring pin 65 mm	RE0033014	2	-
	Spring pin 75 mm	RE0033023	-	2
10	Flow divider	RE0100000	1	1
A	Type plate			
B	Engraved type information and serial number			

¹Available separately from KOOI-REACHFORKS® supplier, is **not** supplied as standard with KOOI-REACHFORKS®.

²Article N° depending on specific model. Please provide serial number when ordering.

Replacement parts list TFE2

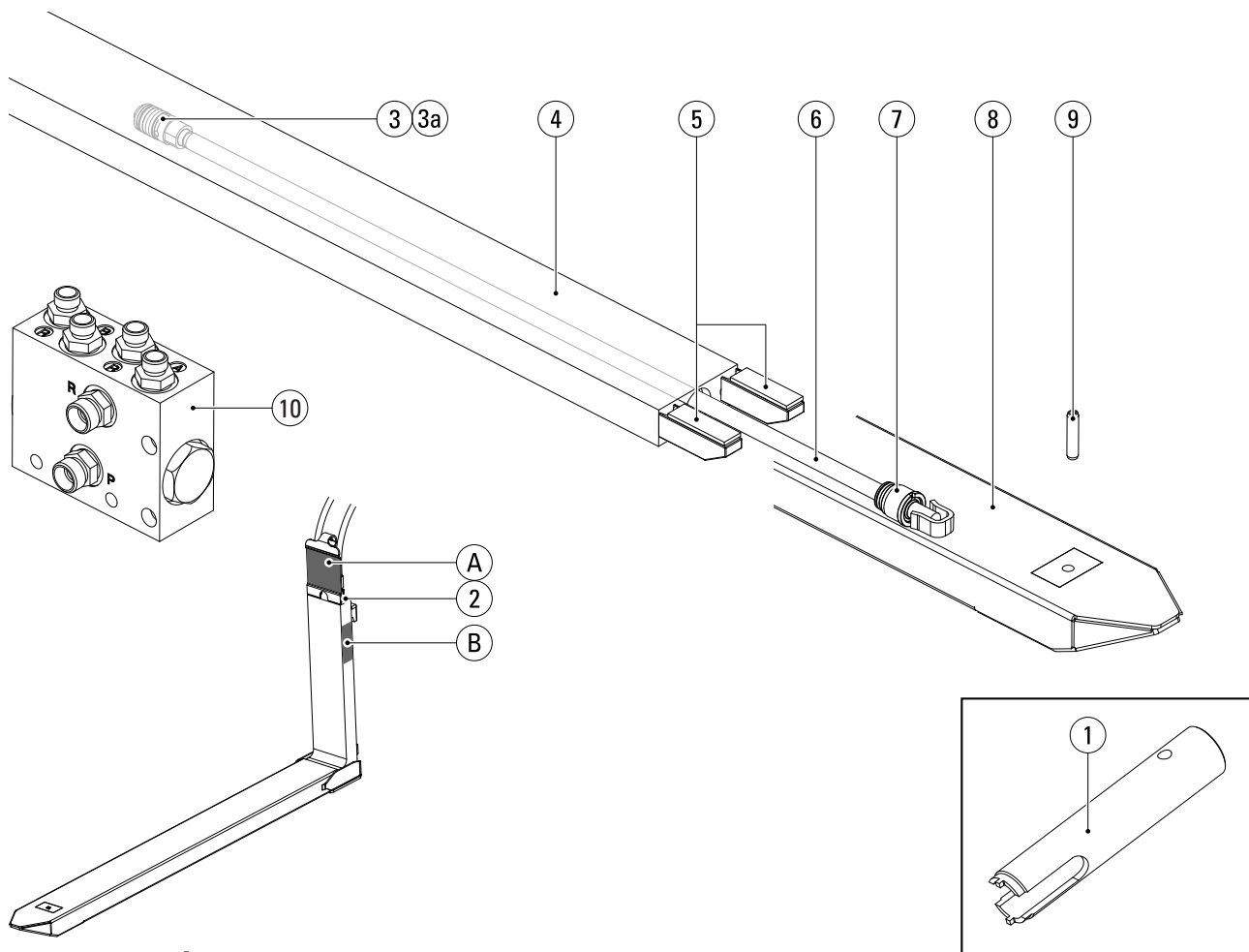

Pos. N°	Description	Article N°	Number of parts per set and type of forks
			TFE2-20
1	Cylinder head spanner	RE0058034	1 ¹
2	Straight male coupling 8L	RE2017000	4
3	Piston Ø30 (for piston rod Ø20)	RE2008001	2
3a	Separate piston seal Ø30	RE0015001	2
4	Inner fork	²	2
5	Wear strip PA6	RE0020000	4
6	Piston rod Ø20	²	2
7	Cylinder Head Ø30 (for piston rod Ø20)	RE2009001	2
8	Sleeve	²	1
9	Spring pin 65 mm	RE0033014	2
10	Flow divider	RE0100000	1
A	Type plate		
B	Engraved type information and serial number		

¹Available separately from KOOI-REACHFORKS® supplier, is **not** supplied as standard with KOOI-REACHFORKS®.

²Article N° depending on specific model. Please provide serial number when ordering.

Replacement parts list RE4

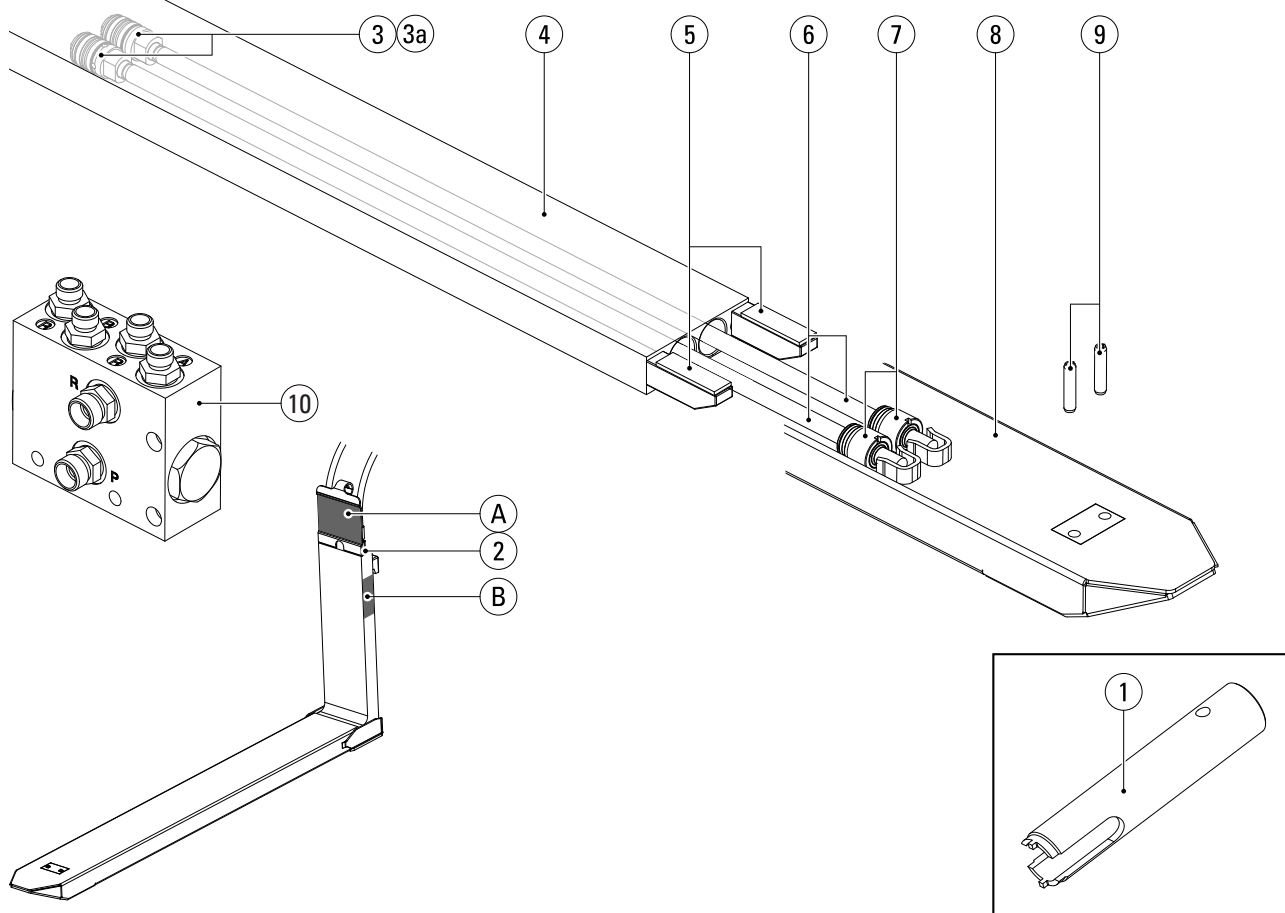

Pos. N°	Description	Article N°	Number of parts per set and type of forks				
			RE4-25	RE4-32	RE4-35	RE4-45	RE4-58
1	Cylinder head spanner (Ø30/35)	RE0058034	-	-	-	-	1 ¹
	Cylinder head spanner (Ø25)	RE0058037	1 ¹	1 ¹	1 ¹	1 ¹	-
2	Straight male coupling 8L	RE2017000	4	4	4	4	4
3	Piston Ø25 (for piston rod Ø16)	RE2008000	4 ³	4 ³	4 ³	4 ³	-
	Piston Ø30 (for piston rod Ø20)	RE2008001	-	-	-	-	4
3a	Separate piston seal Ø25	RE0015000	4 ³	4 ³	4 ³	4 ³	-
	Separate piston seal Ø30	RE0015001	-	-	-	-	4
4	Inner fork	²	2	2	2	2	2
5	Wear strip PA6	RE0020000	4	4	4	-	-
	Wear strip AMPCO	RE0020001	-	-	-	4	4
6	Piston rod Ø16	²	4 ³	4 ³	4 ³	4 ³	-
	Piston rod Ø20	²	-	-	-	-	4
7	Cylinder Head Ø25 (for piston rod Ø16)	RE2009000	4 ³	4 ³	4 ³	4 ³	-
	Cylinder Head Ø30 (for piston rod Ø20)	RE2009001	-	-	-	-	4
8	Sleeve	²	2	2	2	2	2
9	Spring pin 45 mm	10099293	-	4	-	-	-
	Spring pin 55 mm	RE0033015	4	-	4	4	-
	Spring pin 65 mm	RE0033014	-	-	-	-	4
10	Flow divider	RE0100000	1	1	1	1	1

Replacement parts list RE4 (cont'd)

A	Type plate
B	Engraved type information and serial number

¹Available separately from KOOI-REACHFORKS® supplier, is **not** supplied as standard with KOOI-REACHFORKS®.

²Article N° depending on specific model. Please provide serial number when ordering.

³With a stroke of 1200 mm or more, use articles as for type RE4-58

Replacement parts list RE4 (cont'd)

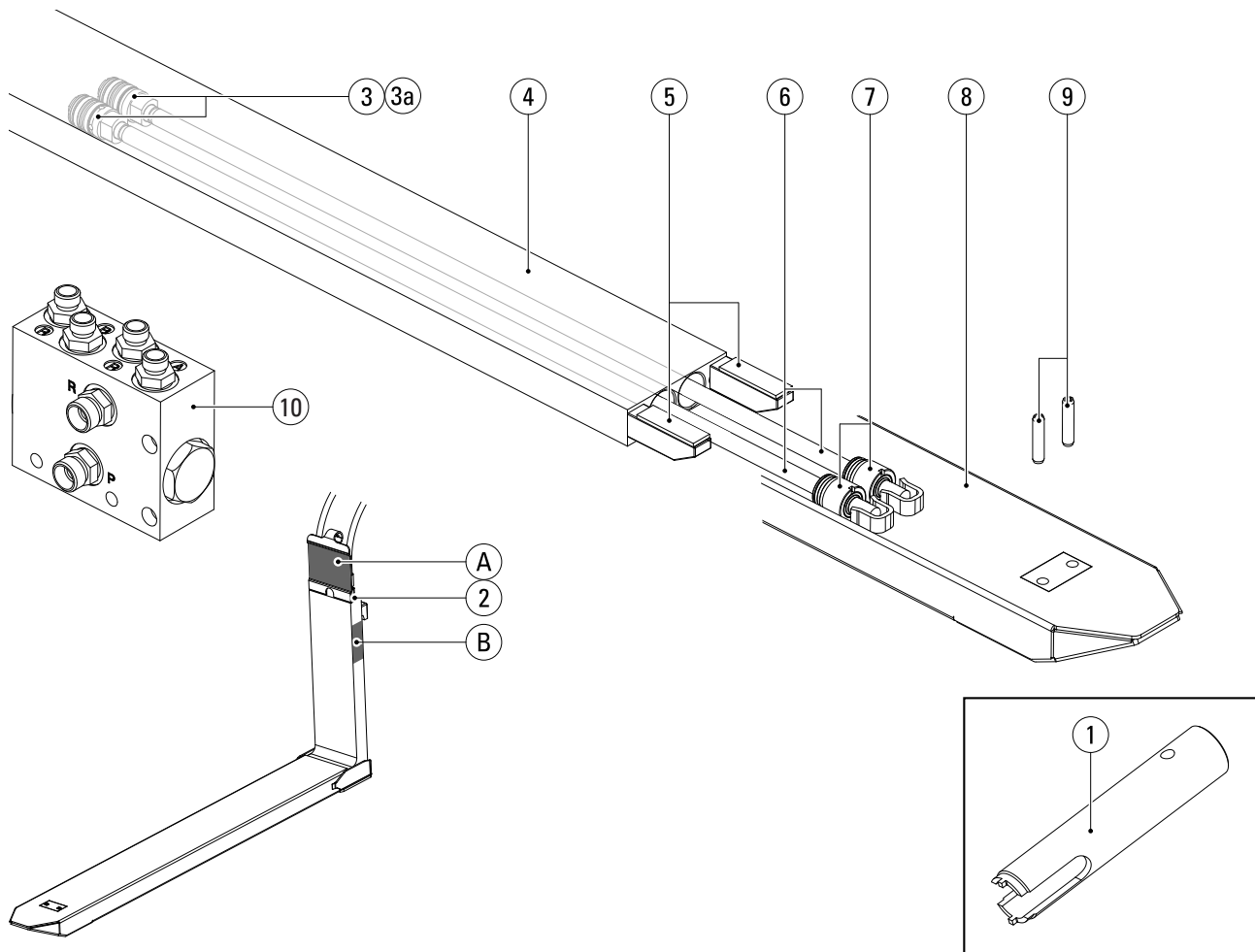

Pos. N°	Description	Article N°	Number of parts per set and type of forks	
			RE4-77	RE4-105
1	Cylinder head spanner	RE0058034	1 ¹	1 ¹
2	Straight male coupling 8L	RE2017000	4	4
3	Piston Ø30 (for piston rod Ø20)	RE2008001	4	4
3a	Separate piston seal Ø30	RE0015001	4	4
4	Inner fork	²	2	2
5	Wear strip AMPCO	RE0020001	4	4
6	Piston rod Ø20	²	4	4
7	Cylinder Head Ø30 (for piston rod Ø20)	RE2009001	4	4
8	Sleeve	²	2	2
9	Spring pin 65 mm	RE0033014	4	-
	Spring pin 75 mm	RE0033023	-	4
10	Flow divider	RE0100000	1	1
A	Type plate			
B	Engraved type information and serial number			

¹Available separately from KOOI-REACHFORKS® supplier, is **not** supplied as standard with KOOI-REACHFORKS®.

²Article N° depending on specific model. Please provide serial number when ordering.

Replacement parts list RE8

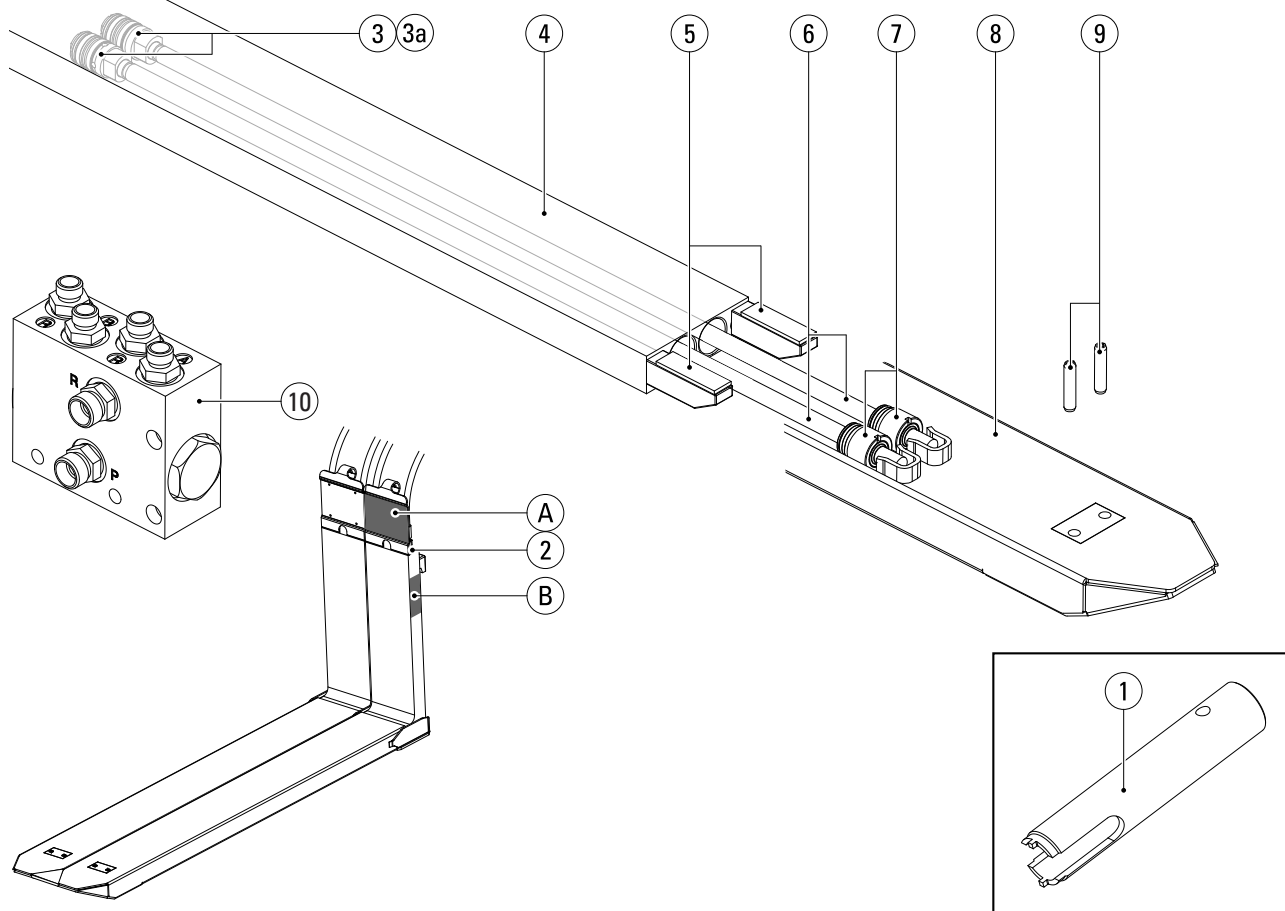

Pos. N°	Description	Article N°	Number of parts per set and type of forks			
			RE8-116	RE8-154	RE8-210	RE8-300
1	Cylinder head spanner	RE0058034	1 ¹	1 ¹	1 ¹	1 ¹
2	Straight male coupling 8L	RE2017000	8	8	8	8
3	Piston Ø30 (for piston rod Ø20)	RE2008001	8	8	8	-
	Piston Ø35 (for piston rod Ø20)	RE2008004	-	-	-	8
3a	Separate piston seal Ø30	RE0015001	8	8	8	-
	Separate piston seal Ø35	RE0015004	-	-	-	8
4	Inner fork	²	2	2	2	2
5	Wear strip AMPCO	RE0020001	8	8	8	-
	Wear strip AMPCO	RE0020010	-	-	-	8
6	Piston rod Ø20	²	8	8	8	8
7	Cylinder Head Ø30 (for piston rod Ø20) ²	RE2009001	8	8	8	-
	Cylinder Head Ø35 (for piston rod Ø20) ³	RE2009004	-	-	-	8
8	Sleeve	²	2	2	2	2
9	Spring pin 65 mm	RE0033014	8	8	-	-
	Spring pin 75 mm	RE0033023	-	-	8	-
	Spring pin 100 mm	RE0033011	-	-	-	8
10	Flow divider	RE0100001	1	1	1	1
A	Type plate					
B	Engraved type information and serial number					

¹Available separately from KOOI-REACHFORKS® supplier, is **not** supplied as standard with KOOI-REACHFORKS®.

²Article N° depending on specific model. Please provide serial number when ordering.

Replacement parts list REE2, REEN2

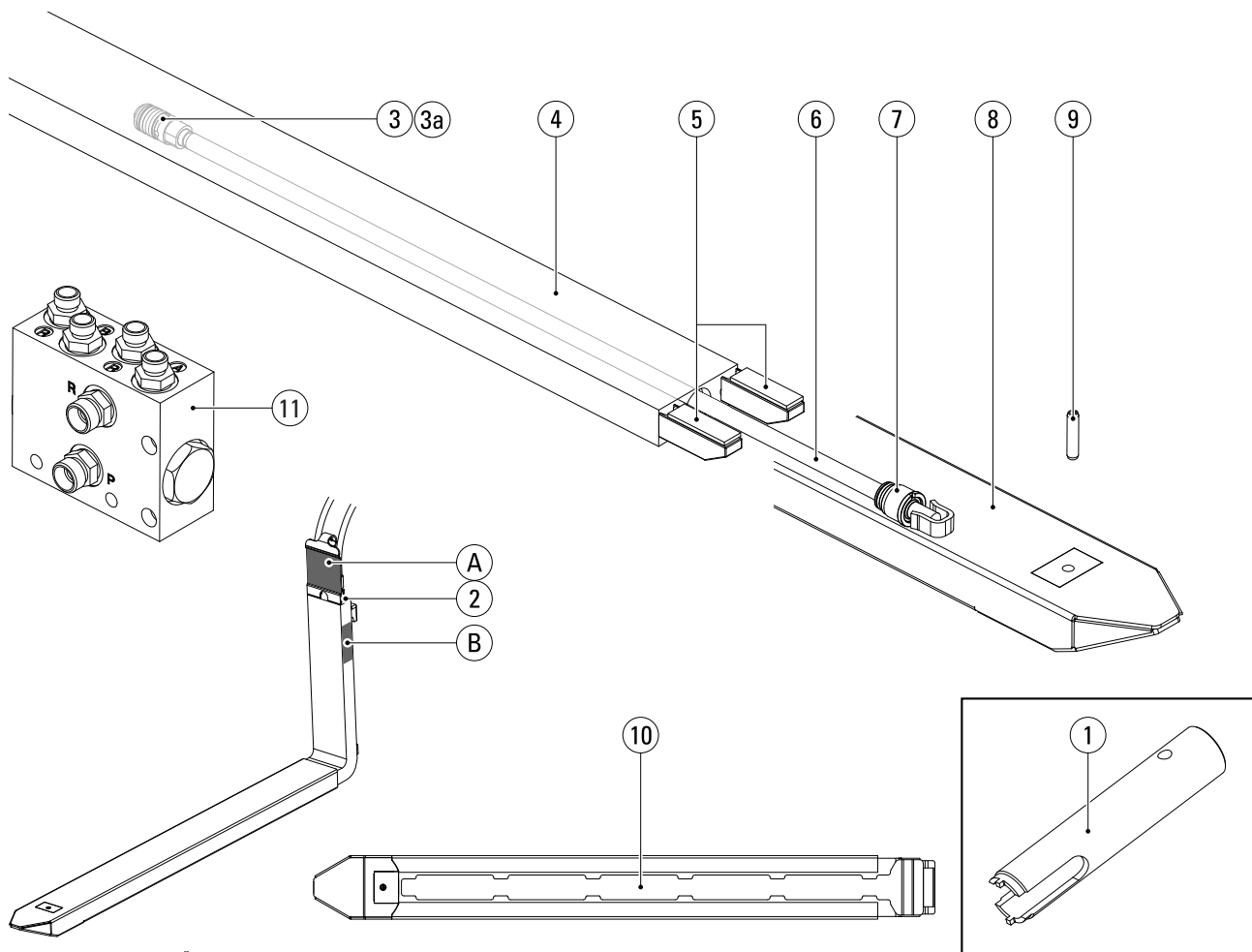

Pos. N°	Description	Article N°	Number of parts per set and type of forks			
			REE2-20	REE2-30	REEN2-30	REEN2-35
1	Cylinder head spanner	RE0058034	1 ¹	1 ¹	1 ¹	1 ¹
2	Straight male coupling 8L	RE2017000	4	4	4	4
3	Piston Ø30 (for piston rod Ø20)	RE2008001	2	2	2	2
3a	Separate piston seal Ø30	RE0015001	2	2	2	2
4	Inner fork	²	2	2	2	2
5	Wear strip PA6	RE0020000	4	4	4	4
6	Piston rod Ø20	²	2	2	2	2
7	Cylinder Head Ø30 (for piston rod Ø20)	RE2009001	2	2	2	2
8	Sleeve	²	2	2	2	2
9	Spring pin 55 mm	RE0033015	2	2	-	-
	Spring pin 65 mm	RE0033014	-	-	2	2
10	Wear plate	²	2	2	2	2
11	Flow divider	RE0100000	1	1	1	1
A	Type plate					
B	Engraved type information and serial number					

¹Available separately from KOOI-REACHFORKS® supplier, is **not** supplied as standard with KOOI-REACHFORKS®.

²Article N° depending on specific model. Please provide serial number when ordering.

Replacement parts list REE4

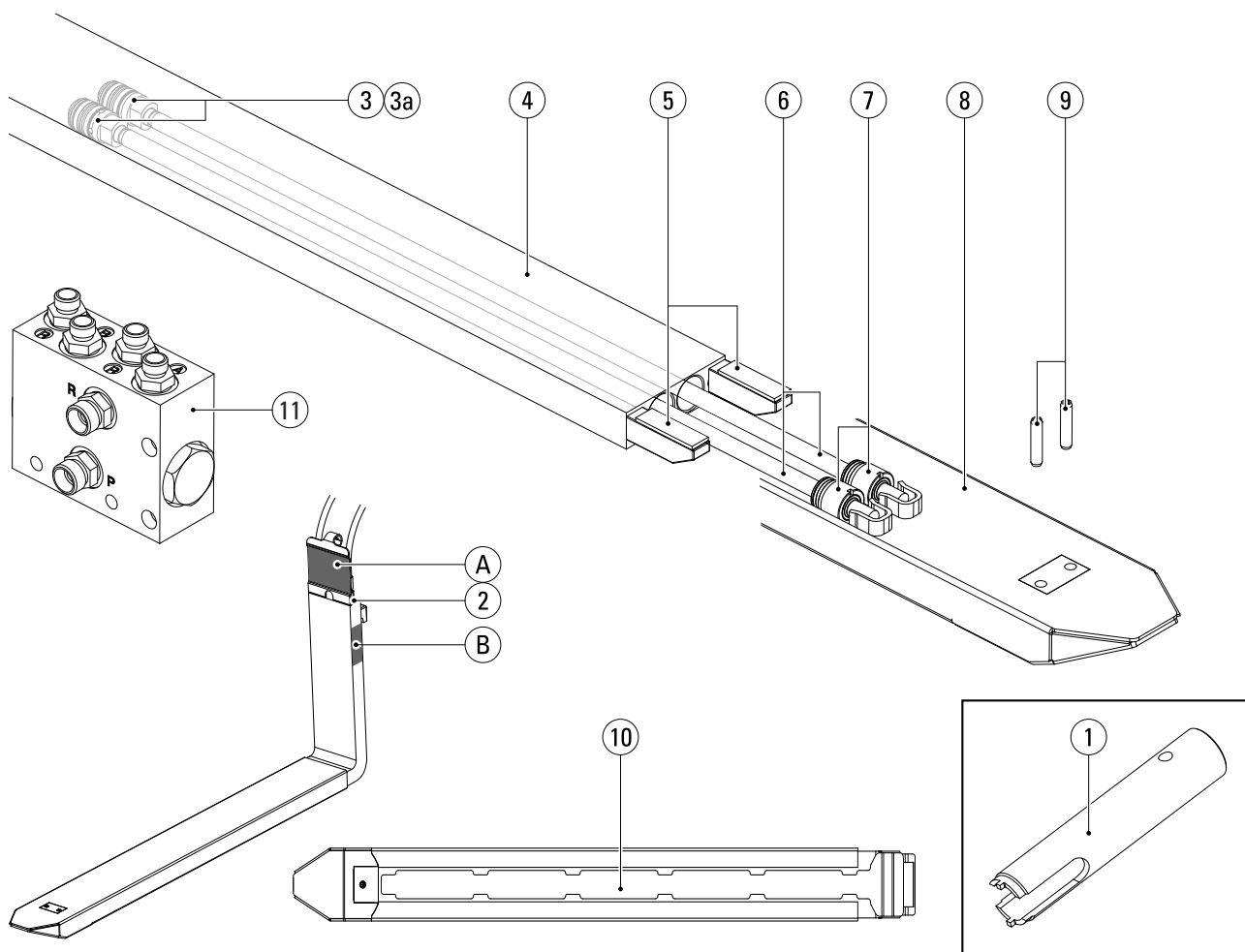

Pos. N°	Description	Article N°	Number of parts per set and type of forks			
			REE4-25	REE4-35	REE4-45	REE4-58
1	Cylinder head spanner	RE0058034	1 ¹	1 ¹	1 ¹	1 ¹
2	Straight male coupling 8L	RE2017000	4	4	4	4
3	Piston Ø25 (for piston rod Ø16)	RE2008000	4 ³	4 ³	4 ³	-
	Piston Ø30 (for piston rod Ø20)	RE2008001	-	-	-	4
3a	Separate piston seal Ø25	RE0015000	4 ³	4 ³	4 ³	-
	Separate piston seal Ø30	RE0015001	-	-	-	4
4	Inner fork	²	2	2	2	2
5	Wear strip PA6	RE0020000	4	4	-	-
	Wear strip AMPCO	RE0020001	-	-	4	4
6	Piston rod Ø16	²	4 ³	4 ³	4 ³	-
	Piston rod Ø20	²	-	-	-	4
7	Cylinder Head Ø25 (for piston rod Ø16)	RE2009000	4 ³	4 ³	4 ³	-
	Cylinder Head Ø30 (for piston rod Ø20)	RE2009001	-	-	-	4
8	Sleeve	²	2	2	2	2
9	Spring pin 55 mm	RE0033015	4	4	4	-
	Spring pin 65 mm	RE0033014	-	-	-	4
10	Wear plate	²	2	2	2	2
11	Flow divider	RE0100000	1	1	1	1
A	Type plate					

Replacement parts list REE4 (cont'd)

B	Engraved type information and serial number
¹ Available separately from KOOI-REACHFORKS® supplier, is not supplied as standard with KOOI-REACHFORKS®.	
² Article N° depending on specific model. Please provide serial number when ordering.	
³ With a stroke of 1200 mm or more, use articles as for type RE4-58	

Production and safety standards

Meijer Handling Solutions B.V. requires its products to be of the highest quality and we can only guarantee this by complying with all applicable international standards and regulations such as:

ISO 9001

Quality management systems - Requirements.

ISO 13284

Fork-arm extensions and telescopic fork arms. Technical characteristics and strength requirements. (safety factor 3 at all times)

ISO 2328

Hook-on type fork arms and fork carriages. Mounting dimensions.

ISO 4406

Hydraulic Fluid Power – Fluids – Method for Coding the Level of Contamination by Solid Particles

ISO 3834-2

Quality requirements for welding. Fusion welding of metallic materials.

CE

European Machine Directive 2006/42/EC



Meijer Handling Solutions B.V.

Oudebildtdijk 894

9079 NG St. Jacobiparochie

Netherlands

Website: www.meijer-handling-solutions.com

Telephone: +31 (0)518 492929

Telefax: +31 (0)518 492915

E-mail: info@meijer-group.com