

Instruction and parts manual

RTE (Rollerized Tine Extenders)

RTE-50
RTE-80
RTE-100

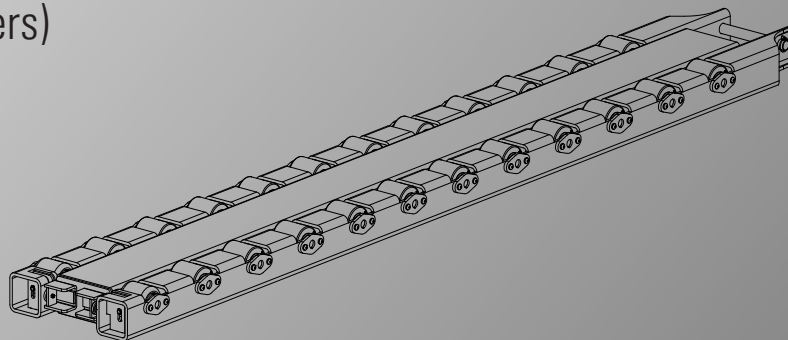

Original instructions

Manual no.: MA15062015-04ENG

Publishing date: 18-03-2024

Language: ENG

Revision: 04

Table of contents

Introduction.....	2
Unintended usage.....	2
Definitions	3
Remark.....	3
(Quality) standards and directives	3
Safety.....	4
Identification.....	5
Maintenance schedule	5
Transportation	6
Installation on forklift.....	6
Operation of the RTE.....	7
Technical specifications.....	8
Part list Assembly steel wheel.....	8
Part list Complete RTE.....	9

Introduction

The Rollerized Tine Extender (RTE) is a fork arm extension developed specifically for handling air cargo pallets. Rollerized Tine Extenders can be used by forklift trucks and can be used with existing fork lift forks.

The RTE can be used in- and outdoors, in temperatures ranging between -25°C and 70°C.

Unintended usage

The use of the RTE for purposes other than those described in this manual is prohibited. The manufacturer is not responsible for casualties resulting from misuse, or deliberately ignoring the regulations.

The company or organization using the RTE must ensure it is only used in accordance with its intended purpose. In cases where the operator is not sure he or she is using the RTE properly and/or safely, without any chance of accidents, the RTE's manufacturer must be requested for approval.

The maximum capacity, as mentioned in this manual and on the machine, may not be exceeded. The company or organisation using the RTE, is responsible for having a residual capacity plate on the fork lift. The static test coefficient used is 3.

Definitions

**Warning:**

Text blocks marked by a “Warning” icon (as shown on the left) and starting with the text “**Warning:**” provide information on actions which may result in serious injury.

**Caution:**

Text blocks marked by a “Caution” icon (as shown on the left) and starting with the text “**Caution:**” provide information on actions which may result in damage to the RTE, parts of the RTE or goods.

Remark

© Copyright 2021, Meijer Handling Solutions B.V. All rights reserved.

Information in this manual, including but not limited to images and text, may not be reproduced without prior written permission of Meijer Handling Solutions B.V.

The information in this manual is provided without any form of guarantee. Meijer Handling Solutions B.V. shall in no case be liable for injuries and damages resulting from use of this manual.

Note that the information in this manual can be modified at any time without prior notice. Note also that this manual can contain technical inaccuracies and misprints. Meijer Handling Solutions B.V. does its best to prevent mistakes in the manual, but can not guarantee it. If you come across misprints or technical inaccuracies or if you have suggestions, please, let us know about it.

Trademarks or product names used in this manual, but are not mentioned here, are trademarks of their respective holders.

(Quality) standards and directives

Meijer Handling Solutions B.V. complies with the following quality standard: ISO 9001.

The RTE complies with the following standards and directives:

- CE (2006/42/EC) - Machine Directive
- ISO 9001 - Quality management systems - Requirements.
- ISO 3834-2 Quality requirements for fusion welding of metallic materials - Part 2: Comprehensive quality requirements

Safety



Warning:

Don't use the RTE in temperatures lower than -25°C / -13°F or higher than 70°C / 158°F.



Caution:

Fork length must be at least 60% of the labelled length of the RTE (see type plate).



Warning:

The RTE may only be used by licensed operators and not by minors!



Warning:

Don't use the RTE for lifting people or animals.



Warning:

Don't operate the RTE while there are people near, under or on the RTE.



Warning:

Don't make any modifications to the RTE without specific authorization of the supplier. If modifications are made to the RTE without the mentioned authorization, all warranty will expire.



Warning:

Don't use a RTE with any failings, before it is expertly repaired or replaced.



Warning:

Perform maintenance work only if the RTE is fully lowered.



Caution:

Re-calculate the remaining capacity and replace the type plate of the forklift.



Caution:

The capacity of the forklift and mounted forks must at least be the same or higher than the capacity of the RTE.



Caution:

The RTE has a maximum capacity it can lift as can be found on the type plate.



Caution:

Always drive with the RTE in the lowest possible position.









Caution:









The field of sight is limited because of use of the load on the RTE.

Identification

Type plate symbols

	Type description		Maximum allowed oil pressure
	Serial number		Production year
	Weight		Extra information
	Max capacity		

Maintenance schedule

N°	Description	Every 100 hours	Every 500 hours	Every 1000 hours	Every 2000 hours
1.	Check wheels bearings for sufficient lubrication. If required lubricate.				
2.	Check all wheels for excessive wear. Replace parts if necessary.				
3.	Check complete RTE once a year or 2000 hours.				

Transportation

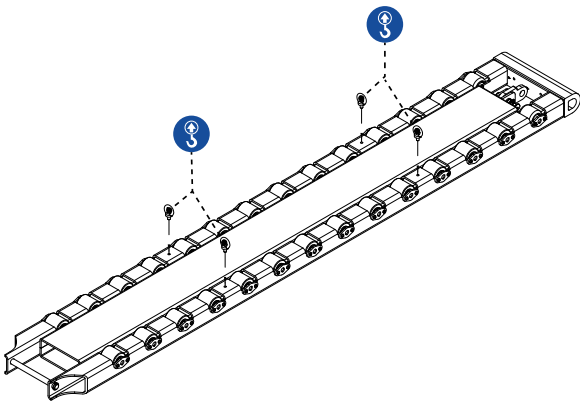

insert four hoisting eyes (M12) in the threaded holes on the locations indicated above. Attach hoisting straps to the hoisting eyes to lift it.



Caution:
Forks must be at least 60% inserted into the RTE's.

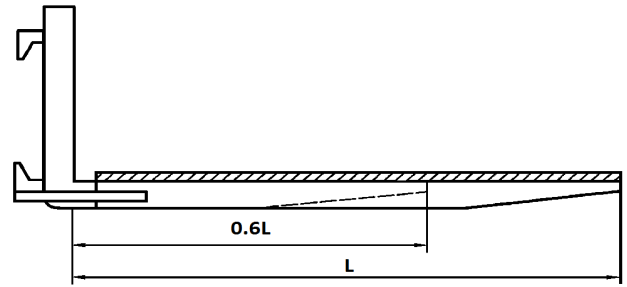

3

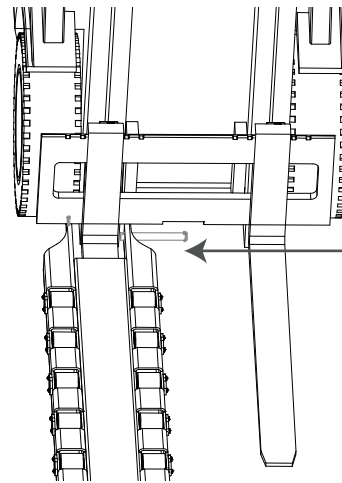

Installation on forklift

1

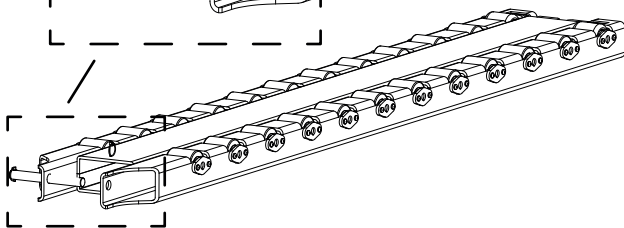
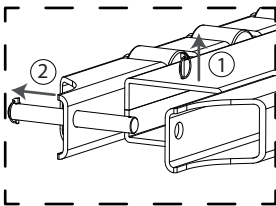

1. Remove the locking pin
2. Remove the steel axle

2

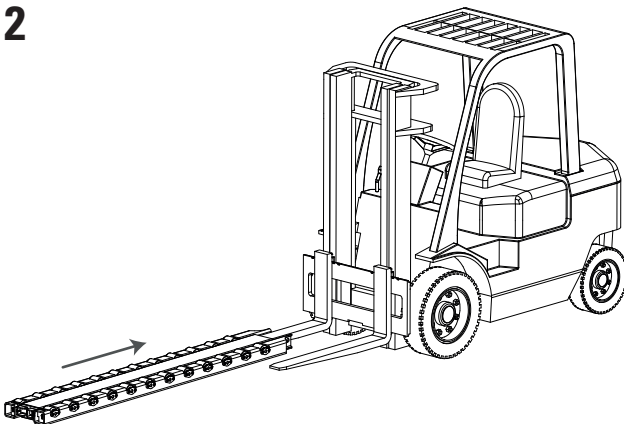

Slide the RTE's over the forklift forks.



Caution:
Recalculate residual capacity of the forklift.



Caution:
The capacity of the forklift and mounted forks must be similar or higher than the capacity of the RTE.

Operation of the RTE

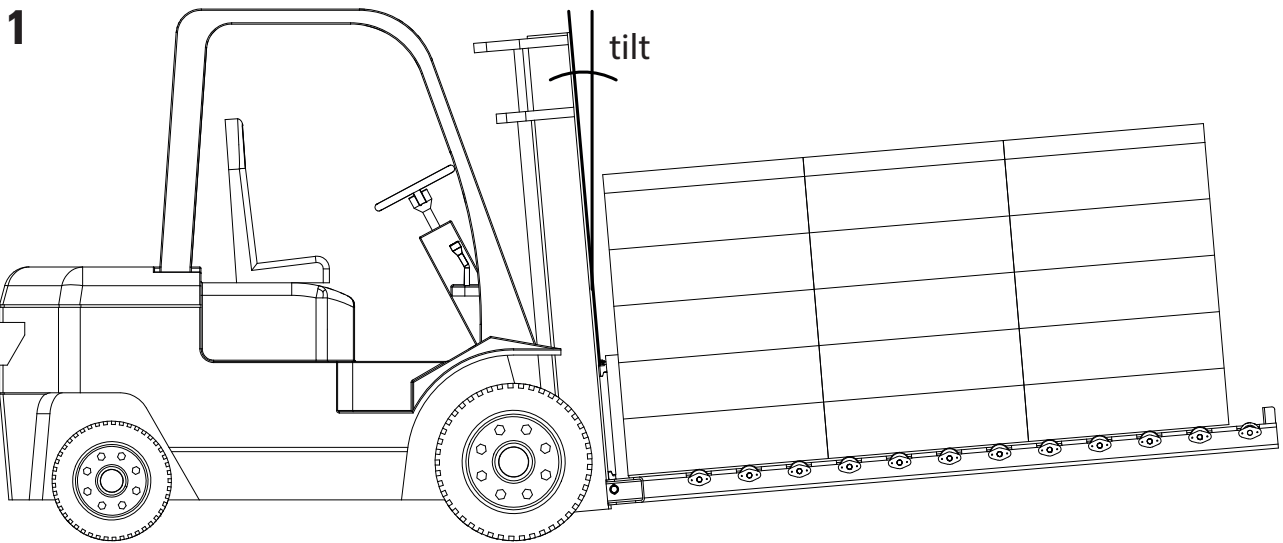

The mast of the forklift must be tilted several degrees backwards to ensure the load doesn't roll off.



Caution:

Make sure at least half (50%) of the load is placed over the fork supported part of the RTE.

2

To secure the load on the RTE, perform the following actions:

- A: Pull plunger back
- B: Grab palletstop
- C: Turn palletstop upwards
- D: Let the palletstop drop
- E: Make sure the plunger springs back when dropping down the palletstop.

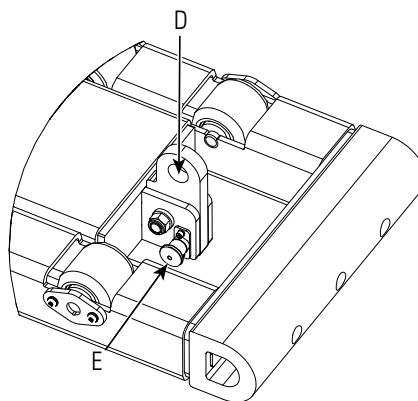
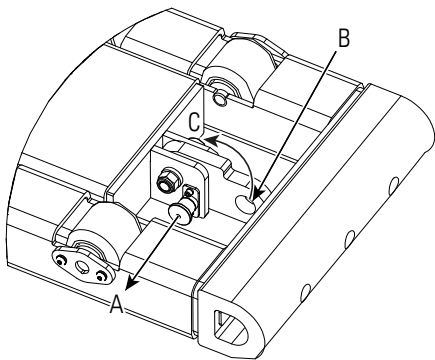

Warning:

If the load can still move, there is the possibility of clamping fingers between the load and palletstop. In that case tilt the mast further backwards.

Technical specifications

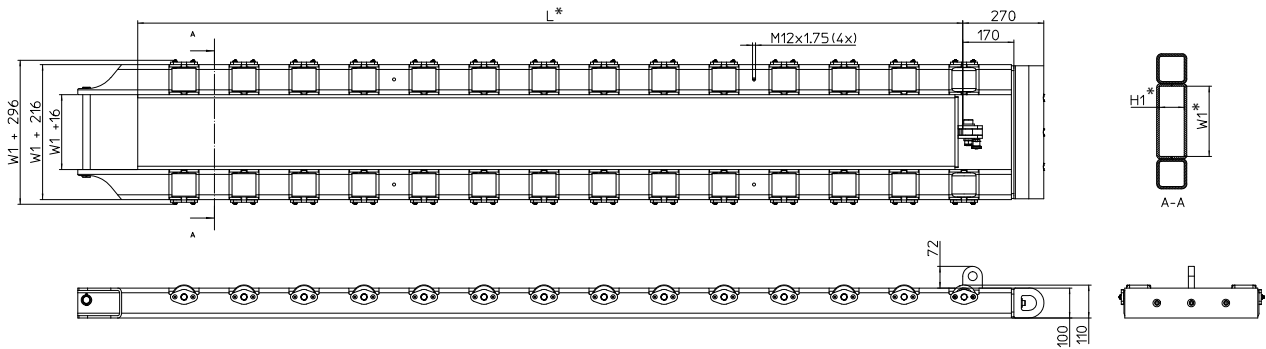

* Depending on specific model

Capacity: See data on type plate
 Centre of gravity: See data on type plate
 Weight: See data on type plate

Part list Assembly steel wheel

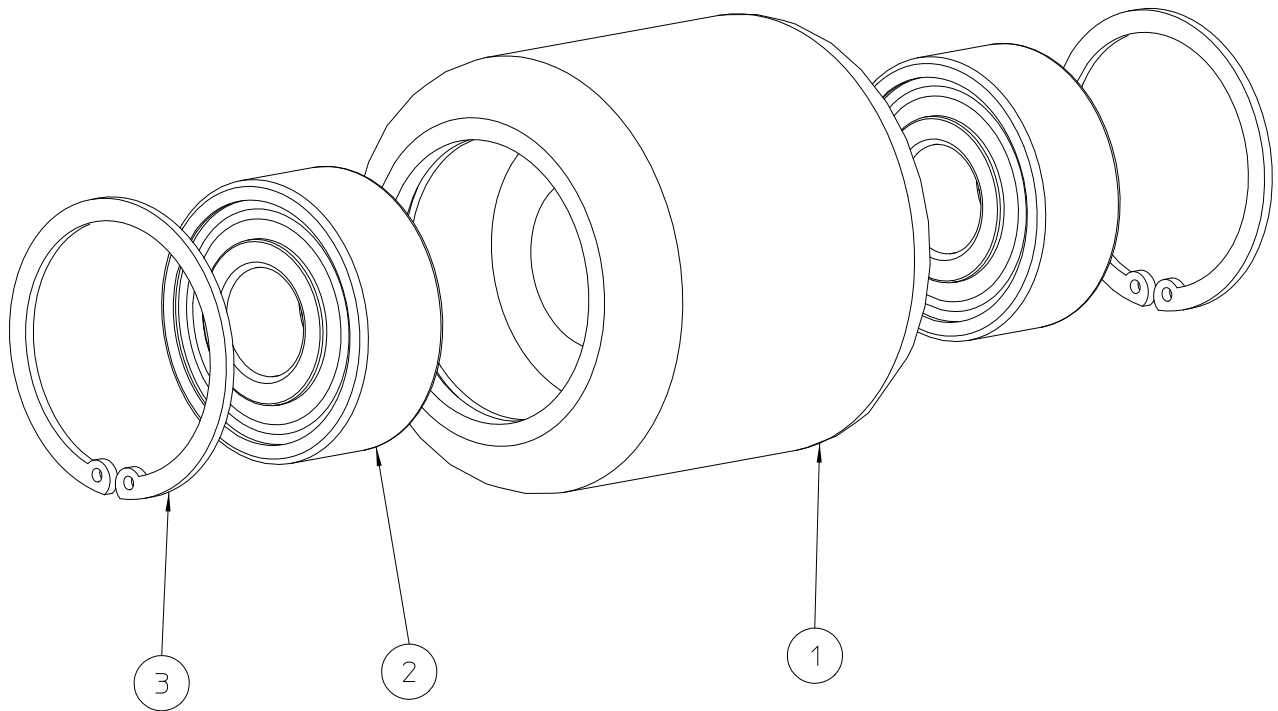

Pos No	Description	Article N°	Total Qty
1	Steel roller	M00010282	1
2	Ball bearing	M00021210	2
3	Retaining ring	M00021240	2

Part list Complete RTE

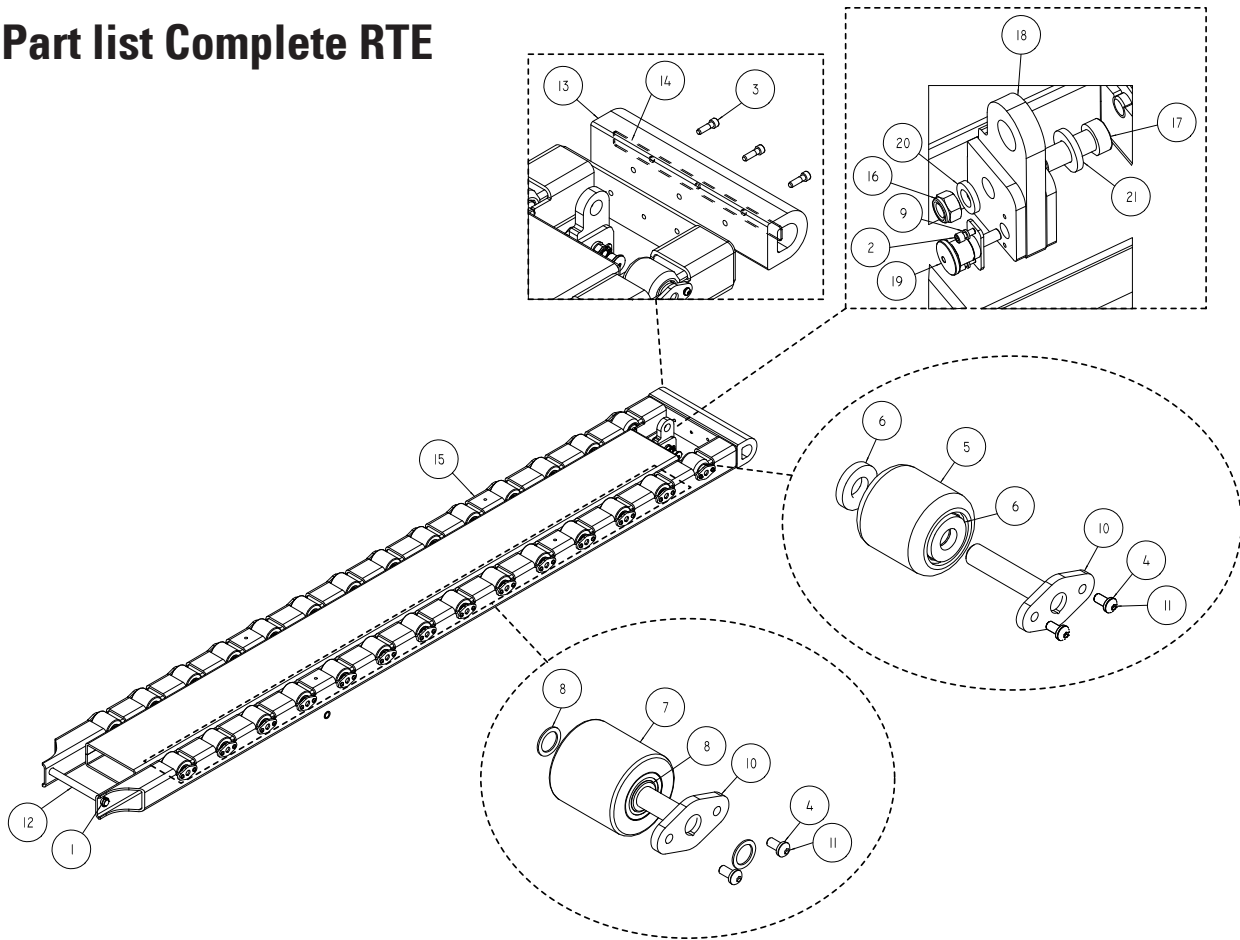

Pos No	Description	Article N°	Total Qty
1	Spring-loaded locking pin	39660 4,5	2
2	Hexagon Socket Head Cap Screw M5x12	07160 M5x12	2
3	Hexagon Socket Head Cap Screw M10x35	07160 M10x35	3
4	Nord-Lock washer M8	37967.080.001	**
5	Assembly steel wheel	M00010280	2
6	Washer M20	M00013170	4
7	Pallet wheel	10129973	**
8	Wedge	M00021384	**
9	Nord-Lock washer M5	M00022418	2
10	Pin	M00022619	**
11	Button head screw M8	M00022626	**
12	Axle	*	1
13	Rubber bumper option	*	1
14	Rubber bumper strip	*	1
15	Frame RTE	*	1
16	Self locking nut M16	12300 M16	1
17	Shoulder screw M16 20x50	10103524	1
18	Palletstop	10103256	1
19	Indexing plunger	10110974	1
20	Washer M16 (extra thick)	10103525	1
21	Washer M20	10103526	1

* Article N° depending on specific model. Please provide serial number when ordering.

** Amount depends on specific model.

Production and safety standards

Meijer Handling Solutions B.V. requires its products to be of the highest quality and we can only guarantee this by complying with all applicable international standards and regulations like:

ISO 9001

Quality management systems - Requirements.

ISO 3834-2

Quality requirements for welding. Fusion welding of metallic materials.

CE

Machine Directive (2006/42/EC)



Meijer Handling Solutions B.V.

Oudebildtdijk 894

9079 NG St. Jacobiparochie

The Netherlands

Website: www.meijer-handling-solutions.com

Telephone: +31 (0)518 492929

Telefax: +31 (0)518 492915

E-mail info@meijer-group.com